

WATERPROOF



Chaozhou **GAT** Bathroom Equipment and Supplies Manufacturing Co., Ltd.

Address: Fengan Dadao, Fengtang, Chaoan, Guangdong, China
(Postcode: 515646)

Tel: +86-768-6856228 Fax: +86-768-6856238

Http://www.gat.net.cn E-mail: cz@gat.net.cn

DEALERS

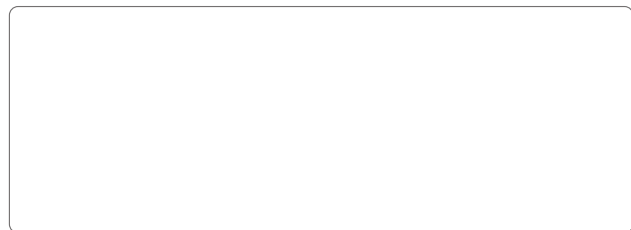

Note: If you have any problems, please contact the dealer who sold and installed the product. They should be able to solve those problems you may have.



ISO9001

GAT CASUAL SANITARY WARE



GAT Casual Sanitary Ware



Steaming Bathroom

Model: GI-1515

Manual

Precaution

Dear user,

Thank you for choosing GAT computerized steaming bathroom, Now you own one of the many perfect products manufactured by GAT Co..

For your benefit, please observe the following precaution:

1. To reduce the risk of bodily injury, electric shock, fire, and damage to the equipment, observe all warnings contained in this manual.
2. When unpacking your new GAT product, please check for missing or damaged items, if any item is missing, or if damaged, do not install or operate this product, contact your GAT dealer for assistance.
3. Before installation and using, please read this manual thoroughly. This manual must be owned by the end user. And retain it well for your reading for the future.
4. There is no parts of the computer control which can be repaired by user themselves, do not unpack the computer control yourselves if the electrical parts of this product do not work. You should inform the dealer to check and repair it. Our Company would not be liable for the electrical parts otherwise user unpack the computer control themselves.
5. All information in this manual is based on the latest product, it is available at the time of publication. GAT Co. reserves the right to make changes in product characteristics or packing, and all changes will be without notice.

Contents

Features and Parameters	1
Installation	2
Operation	7
Maintenance	12

6. Troubleshooting

Symptoms	Probable Causes	Recommended Action
No power to the steaming bathroom	①. General powerplug connects loose to the electricity outlet or disconnected wiring. ②. GFCI trips.	①. Connect the plug to the electrical outlet properly or check, repair, replace the cord. ②. Check if there is creepage on the circuit, press the resume button on the GFCI.
The control system shuts down automatically	①. Control connects loose to the electrical outlet. ②. Temperature detector does not work.	①. Plug into the electrical outlet tightly and fasten the screws on the ends of the plug. ②. Replace the temperature detector.
The control LCD non-display	①. No power to the control panel. ②. Fuse of the control is burn-out.	①. Check and connect the control panel to the control properly. ②. Replace the fuse.
steaming generator does not work	①. Steaming generator disconnects to the control. ②. Thermal tube does not work. ③. No water to the steaming generator or not enough. ④. Steam outlet is blocked. ⑤. Setting temperature is lower than temperature indoor. ⑥. Setting time runs out. ⑦. Thermal break shut down.	①. Check and plug in, Plug the connector tightly. ②. Replace it. ③. Check the piping and electromagnetic valve, remove obstruction or replace the valve. ④. Remove obstruction. ⑤. Reset the temperature or wait for the indoor temperature lower down. ⑥. Restart the system. ⑦. Resume the thermal break or replace it.
Steaming generator can not drain automatically	①. Drainage electromagnetic valve disconnects. ②. Drainage electromagnetic valve does not work.	①. Reconnect cord of electromagnetic valve. ②. Replace electromagnetic valve.
No lighting	①. Lamp or rectifier does not work. ②. Wire disconnects. ③. the control box no power output.	①. Check the lamp or rectifier, repair or replace. ②. Check and reconnect wiring. ③. Check power output of the control box.
Exhaust fan does not work	①. Exhaust fan does not work. ②. Exhaust fan disconnects.	①. Repair or replace exhaust fan. ②. Reconnect wiring.
Telephone receiver is not available	①. Telephone receiver disconnects to the telephone indoor. ②. Telephone indoor is of anti-theft-dialing lock.	①. Reconnect telephone wiring. ②. Turn off the anti-theft-dialing lock.
Radio effect is not good enough	①. Antenna is not spread. ②. Antenna position is not proper.	①. Spread the antenna. ②. Adjust antenna position.
Remote control does not work	①. Capacity of battery is too low. ②. Battery install wrong direction.. ③. Remote control is not available..	①. Replace battery.. ②. Install battery properly. ③. Replace the remote control..

Notice: ①. Call dealer or qualified electrician for maintenance when meeting problems.
②. Must not replace, put on or take off the electrical parts when checking problems by user themselves.

Maintenance

1. Keep the acryl surface of the shower panel from crashing by a sharp edge. If the surface is crashed or there is some blot which can not be removed by scrub, using #1500 sandpaper to polish it and apply some toothpaste on a soft cloth to wipe it.
2. Using special cleanser to clean-up the shower panel. The cleanser contain no such organic solvents as acid, alkali, ketone and aldehyde.
3. Need not polish the plating parts of the shower panel to prevent from affecting the brightness of the surface. Keep benzine and acid (such as sealant) away from the plating parts avoid eroding when being in installation.
4. Shut down the water and electrical supply if the shower panel is not in operation for a long time. Keep it in a dry and ventilated circumstance and far away from volatile chemicals.
5. Clean-up the filter at the joint of the water pipe to ensure the fluent flowing.

Feature and Parameters

1. Specification and Function:

complete name: Computerized Steaming Bathroom;

model: GL-1515;

size: 1500x1500x2200mm(Chinese style), 1500x1500x2290(European style);

glass color: White or Blue;

water protect level: IPX5

function:

- | | | |
|------------------------------|------------------------------|---------------------|
| ◆Computer Control | ◆Mirror | ◆Ozone Disinfection |
| ◆Steaming Bath | ◆Cool&Hot Water Wrench Valve | ◆Ventilation Fan |
| ◆Time Setting | ◆Thermal Faucet (optional) | ◆Roof Lamp |
| ◆Top Shower | ◆LCD TV (optional) | ◆Background Light |
| ◆Flexible Sliding Shower | ◆Audio Input | ◆Double Layer Shelf |
| ◆Backside Atomization Nozzle | ◆Telephone System | ◆Single Layer Shelf |
| ◆Sole Massage Device | ◆FM Radio | ◆Towel Bar |
| ◆Massage Backrest | ◆Alarm System | |

2. Water and Electric Technical Parameters

Power Parameters				Water Supply Parameters			Diameter of the Pipe Joint	
Voltage	Frequency	Control Voltage	Steam Generator Power	Supply Pressure	Operative Pressure	Rate of flow	Cool&Hot Water Supply	Drainage
AC200V ~AC240V	50HZ /60HZ	DC12V	4.1kW	≥0.02 MPa ≤0.7 Mpa	≥0.2 Mpa ≤0.4 Mpa	8~10L/min	φ 15	φ 40

3. Product Size, Water and Electricity Preparation

Installation steps

Install tub and aluminium alloy board fixed

frame:

Take the tub out of carton, place the tub on a level area indoor location, adjust base stand to level upper tub surface;

Insert tub drainage hose into prepared waterspout: keep the inlet depth less than 10cm; (you can lengthen hose accordingly with same diametrical hose if waterspout faraway from installation location, please carefully check tie-in with plastic sealed against leakage).

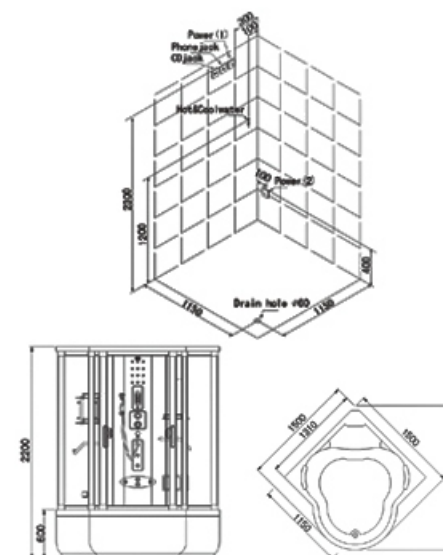

Installation

1. Caution

- 1.1. The installation of this product must be made by qualified electrician or professional people who is appointed by GAT dealer.
- 1.2. The local electric parameters must be accord with electric parameters of this product.
- 1.3. The power supply wire of this product must permanently connect to fixed wiring. This product should be supplied through a residual current device (RCD) having a rated residual operating current not exceeding 30mA, and test it if work well.
- 1.4. The product has been carefully inspected to rigid quality standards before shipment, for ensure the safe using and high performance, do not modify, add, or reduce any water or electrical parts without manufacturer's permission.
- 1.5. When connection the water supply, place two (one for cool water and the other for hot water) general water valves in the water supply outlet on an easy-operationed place.

2. Tools

- | | | | |
|-----|---|-----|-------------------|
| 2.1 | “+”shape screwdriver,“-”shape screwdriver | 2.2 | stepladder |
| 2.3 | 8-10、12-14 open wrench, adjustable wrench | 2.4 | adjustable wrench |
| 2.5 | electric drill | 2.6 | measure ruler |
| | | 2.7 | gradienter |

3. Installation steps

3.1 mounting tray with main board fixed frame:

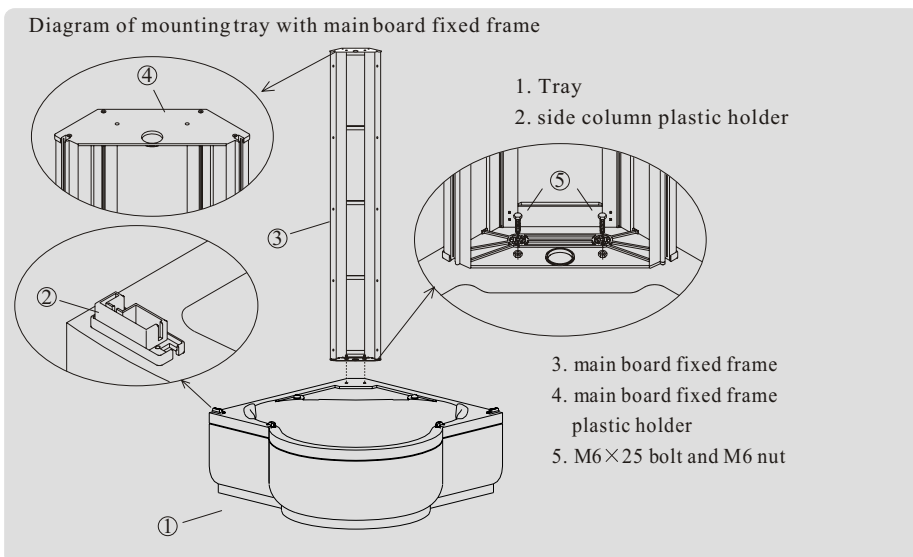

4. Using medication steaming

Find out the medication drawer on the underside of aluminium alloy board, Pull the drawer out, place the medication (or balm) into the drawer, then push the drawer back to original state. when you open the steaming function, you will taste the medication steaming bath.

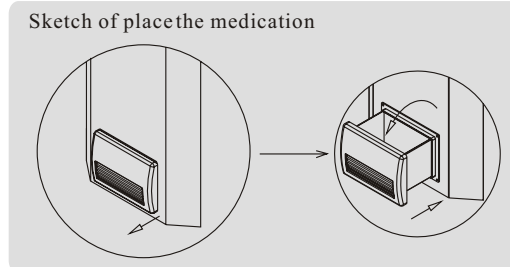

5. Operation of the Thermal Faucet(Optional)

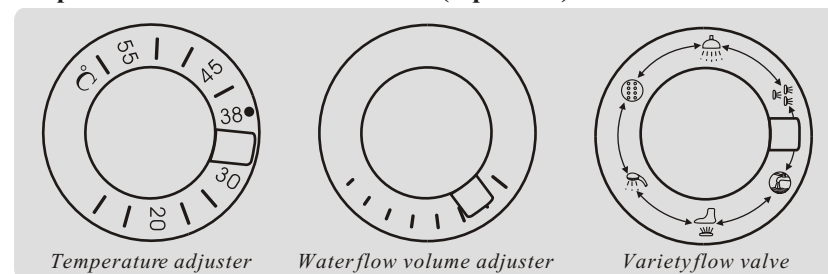

If your steaming bathroom is configured thermal faucet, you could:

- a. Adjust the water temperature for bathing: turn the temperature adjuster according to the sign on the panel, when the handle point at 38°C, the handle will be locked, if you need to turn the temperature up continue, you should press the handle and turn the handle point at high temperature.
- b. Adjust the water flow volume: turn the water flow volume adjuster.
- C. Choose the function which you desire: turn the variety flow valve, make the handle point at the function sign which you desire.

●. Disinfection:

After manually shut off the system, the disinfection function automatic on, and the sign shows on LCD, after 3 minutes the function automatic shut off.

●.Auto-drainer:

After manually shuts off system, the Off sign shows on LCD, and the drainage electromagnetic valve starts and bottom nozzle sign flashed ,after 2 minutes the drainage electromagnetic valve shut off.

●.Alarming:

Touch press alarming key, all functions except lamp and exhaust fan shuts off, "HELP" sign shows on LCD and speaker sends alarming . Under alarming mode , only power key available in use.

3.3 Operation of remote control

All the functions and settings on control panel can be controlled by remote controller. Function of the buttons please refer to the function of computer control panel.

Caution: The remote control is not water-proof. Please keep it away from the water.

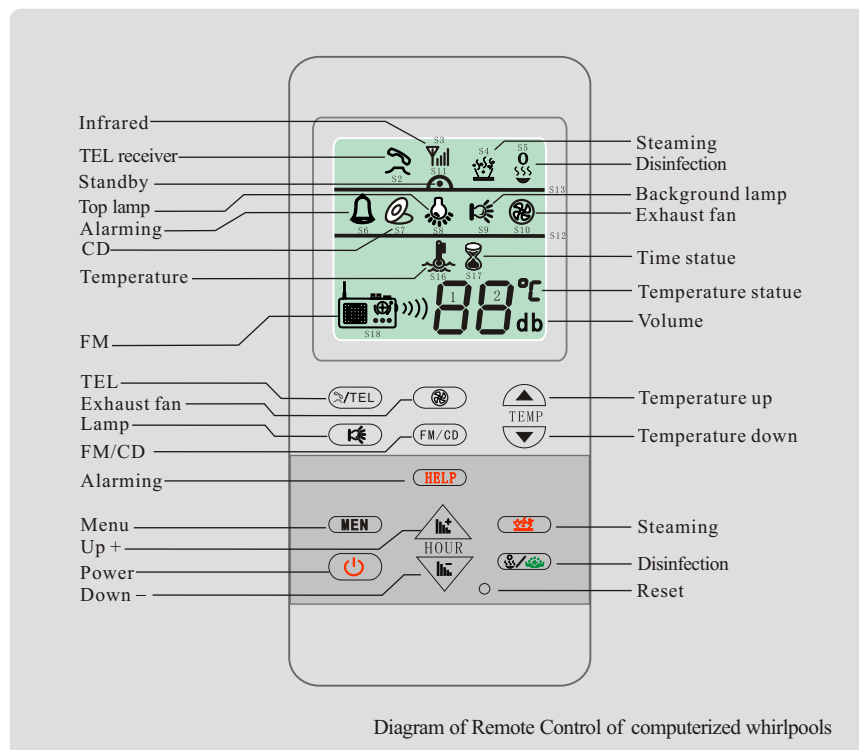

Check all packaging of the product, if there is nothing wrong, go ahead the installation;
Place the tray level at indoor location, adjust base stand to level upper tray surface;
Fasten main board fixed frame on tray with M6x25 bolt and nuts;

3.2 mounting frontal glass enclosure

Fasten door column which is locked plastic holder onto track proper location below and upper with M4x8 screws;

Fasten connector in the correct direction to below and upper joint ends of side column with M4x20 screws;

Insert fixed glass into door column glass flute on track's way, level side column (which is fasten connector) with track, and let fixed glass fully into side column glass flute, use M4x12 screws fasten side column to tracks by connector.

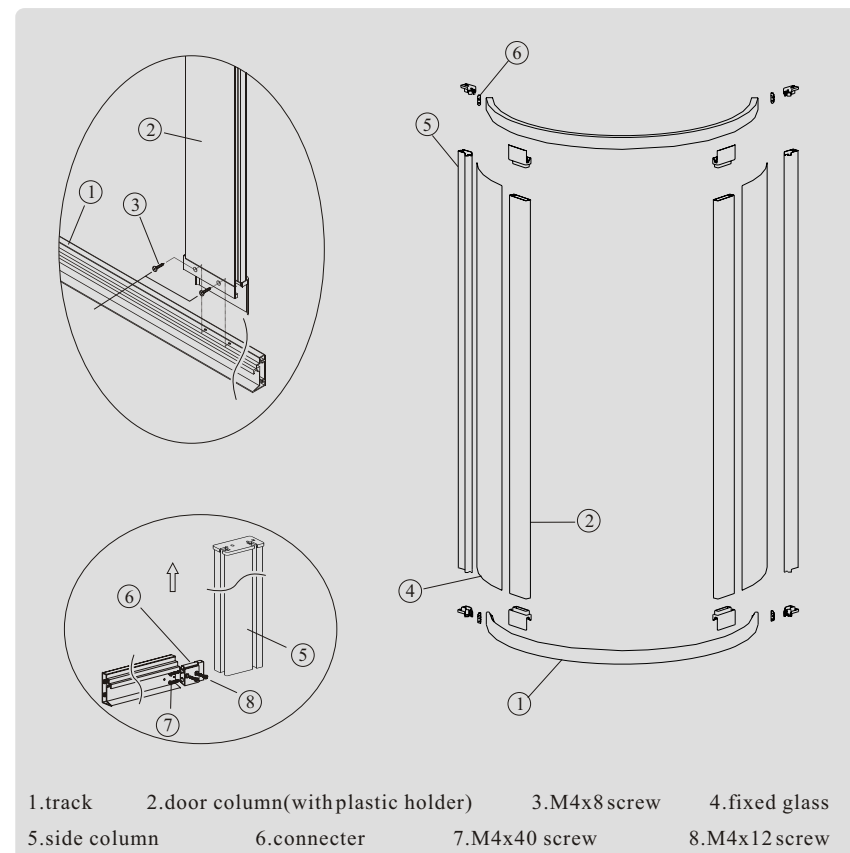

3.3 Mounting glass enclosure, top cover, main board, glass door:

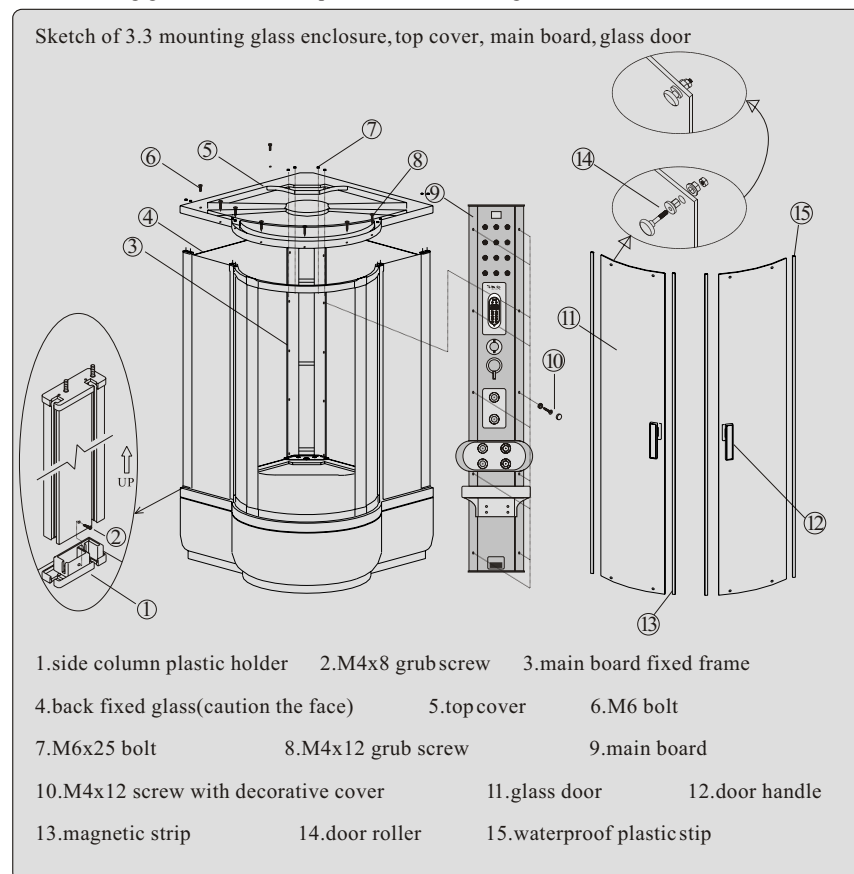

Insert back fixed glass into main board fixed frame glass flute, be careful for damage. (caution the glass face, the plated surface should be out).

Clean up assembled frontal glass enclosures, put it onto front part of tray, insert side column into side column plastic holder which has been fastened on the tray surface, and make the back fixed glass cut in side column glass flute.

Place top cover onto installation locations, level the side column and the hole in top cover, fasten with M6 bolts. Fasten top cover and main board fixed frame by M6x25 bolt and nut. Fasten top cover and track by M4x12 screws.

In the above steps, when insert the fixed glass into the glass flute, there is some gap, insert flexible waterproof plastic strips into the gap. You may use some liquid soap for inserting easy.

● FM/CD/TEL :

*Touch press 1st time, FM starts, the channel frequency and volume sign shows on LCD, press Tun+/- key to adjust max and minus volume. press MEN key and FM sign flashes, press Tun+/- key to get choice channel; As FM is on, touch press M1/M3 key to receive current channel as CH01/CH03, touch press M2/M4 key to receive current CH02/04 channel. As FM sign flashes, touch press M1/M3 key to save current channel as CH01/CH03, touch press M2/M4 key to save current channel as CH02/CH04.

*touch press 2nd time, CD starts, press Tun+/- key to adjust choice volume, in 5 seconds the system restore display "CD".

*touch press 3rd time, Dial-out TEL starts (if need exit, press longer FM/CD/TEL key), LCD show sign "TEL", only bottom lamp and exhaust fan are on and other operation automatically shuts off, the speaker send prompt sound, press the number key 0~9 which is on the control panel to call, and the number will show on LCD, if the line's busy, please press FLASH key then press REDIAL key to re-dial TEL number, in calling, press TUN+/- to adjust choice volume, in 5 seconds the system restore to display "TEL", after Tel, the operation restore to original status; On receiving TEL, the TEL sign flashes on LCD and speaker send vibrant ring, if now the FM and CD is on, it automatically shuts off, press TEL/FM/CD key to receive TEL. under TEL mode, only bottom lamp is on and other operation shuts off, after Tel, the operation restore to original model.

● Steaming:

Touch press steaming key, start-up the steaming function, the water would automatically flow into the steaming generator, the heating system would start to work when the water reach the safety water level (this would take about 15 seconds), the steaming sign shows on LCD, steam would come out in 3 minutes approximately. The steaming function default 45°C, press MENU key, the TEMP sign shows on LCD, press TUN+/- to adjust steaming temperature from 20 to 65, in 5 seconds the system restore to original display (if the temperature you set up under the room temperature, the steaming generator will can't work). This steaming bath system is full automatically computerized, to make steaming generator works effective and steam comes out constantly, the system would come into a automatic procedure at once as soon as it starts. The heating and water supply systems of this unit are controlled automatically in accordance with the water level inside the steaming generator. The steaming generator would stop for a few seconds if the water flow into it when it is in operation and the steaming sign flashes on LCD.

Note: To ensure the safety and performance of this unit, the steaming bath system setup protection function:

1. if the water level is lower than the safety level, after 20 seconds, the alarming function (refer to Alarming function) start-up.
2. When steaming generator is working, if the system verify current temperature over 65°C, the alarming function (refer to Alarming function) start-up.

3.2 Operation procedure for control:

Sketch of Control Panel

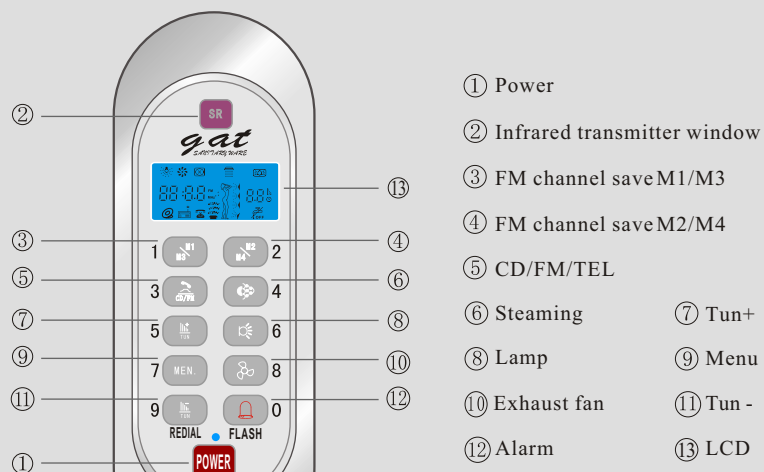

Sketch of the LCD

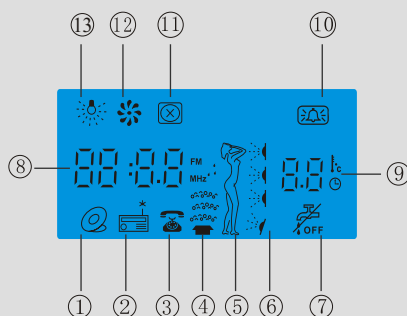

●. Power :

Touch press power key to start panel, LCD flashed and show dynamic “GAT SANITARY WARE”, current temperature and bathing figure sign .In 45 minutes, system willshuts off automatically, press MENU key as the Timer sign shows on LCD,press Tun+/- key to adjust timer from 1 to99 minutes. When the system shutoff automatically, you can restart the system if need to continue.

●. Lamp :

press lamp key 1st time , the top lamp is on only(AC220V 30W), the 2nd time the background lamp(AC12V 30W)is on only, *the 3rd time top and background lamp are all on , *the 4th time all lamp shuts off.

●. Exhaust Fan :

Press fan button, first time the exhaust fan on, second time off.

Carry the main board into the bathroom and fasten it on the fixed frame by M4x12 screw, then screw on the decorative cover.

Mount two door roller into prepared 2-holes upside of the glass door, attach this parts into upper track U shape flute, take another two door roller into blow track U shape flute, then aim and through the prepared 2-holes underside of the glass door, fasten the two roller. Assemble the door handle on the door. Mount the other glass door with the same way. Attach waterproof plastic strips and magnetic strips to the glass door, if there is some gap when the door closed, adjust the acentric -screw-sets, make sure the door slide smoothly and magnetic strip close tight, put decorative cover onto nuts.

3.4 Finish the mounting

Assemble the goods shelf, seat and connect the sole massage device pipe.(see the sketch)

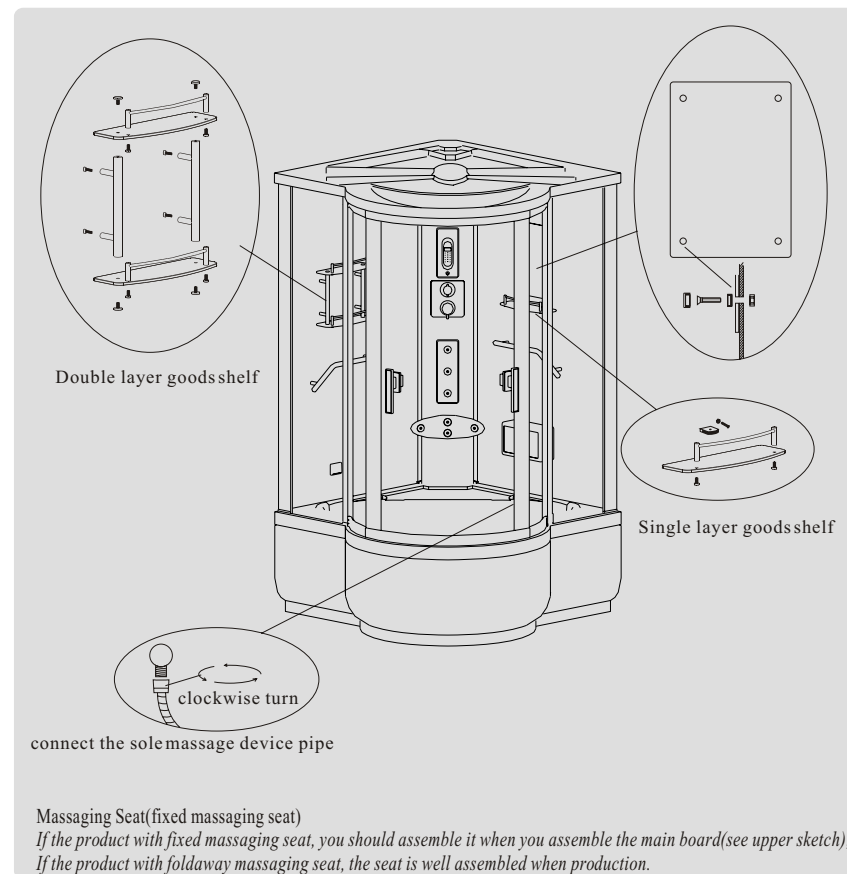

Clean the whole steaming bathroom, complete the mounting.

4. Electric connection

Some joint of the cord is apart for packing. Contain: roof lamp, speaker, ventilation fan. Let these joints through the hole in back of the top cover. Properly connect the cord according marks, make sure the joints matching correctly.

Connect the grounded cord of the bathroom to the protected indoor grounded system and test it. It is forbidden to connect the grounded cord onto water and gas pipe.

Power Supply Control Box connection sketch

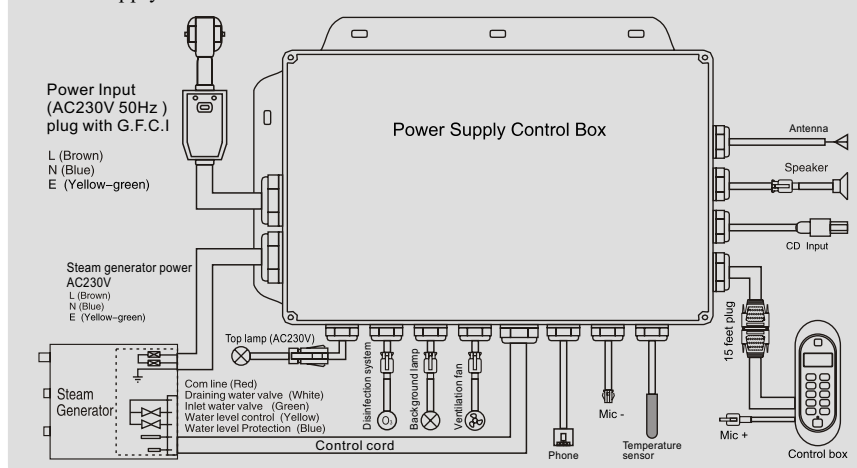

5. Water connection

The joint of the top shower is apart for packing. Let top shower pipe joints through the hole in back of the top cover, connect the joint to the top shower on the top cover.

The drainage pipe of the steaming generator, when turn off the whole control system, the high temperature water (if you have steaming bathing) which is in the steaming generator will be drain, make sure to properly connect it with the drainage below the tray.

Connect the hot&cool water supply hose to indoor prepared tie-in, caution which is hot water or cool water (refer to the panel of hot&cool water wrench valve), the connection parts must use attached by our packing.

Caution: To cut off the water supply easily after finishing your bath anytime, please place two general water valve between the supply outlet and bathroom inlet on a easy-operated place.

Insert tray drain hose into prepared waterspout drainage, keep the inlet depth less than 10cm.

Sketch of water supply

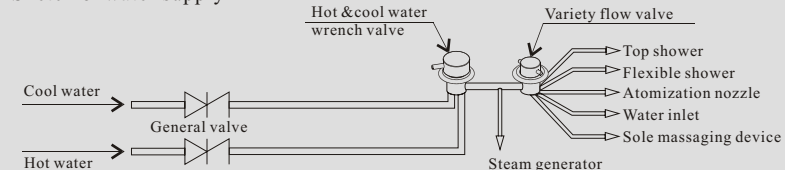

6. Finishing the installation

According to the operating instructions, have a thorough check on the electric connection and water supply pipes. Make sure all the preparation work is completed. Have a electricity water supply test. Make sure the unit operates at its normal conditions, and then move the mounted steaming bathroom to the right position.

Operation

1. Caution

- 1.1 Don't connect the power plug with wet hand;
- 1.2 Person who have high blood pressure, asthma, heart disease, intelligence impediment or drinking wine should use steaming bath cautiously;
- 1.3 Children must be accompanied with adult when using steaming bath;
- 1.4 Don't approach the steam outlet to prevent from burning by the heat steam when using steaming bath;
- 1.5 When you using the steam bathroom, If there is some abnormality state, cut off the power supply, check according the troubleshooting table. If you can not resolve, contact the dealer or appointed qualified electrician for maintenance.
- 1.6 When replace the built-in battery in the remote control, must remove the battery and hand it in separately at an officially assigned collection point.

2. Operation of variety flow valve

Turn on the general valve of water supply, pull up the wrench valve to make the water overflow and turn it to adjust the water temperature. when the water temperature is steady, turn the variety flow valve to select function according to your desire including foot massage, overflow from portable shower head, fixed top shower head, faucet of the bathtub.

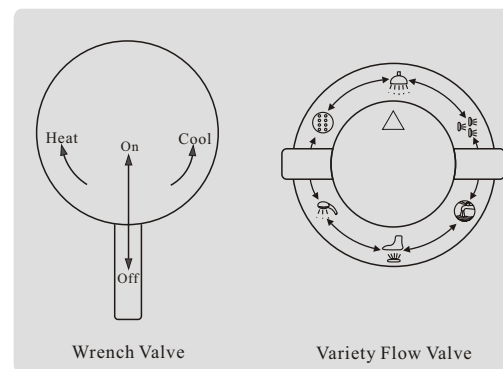

3. Operation of control panel and remote control

3.1 Connect the plug to the electrical outlet, the plug with a plug protected by Ground-Fault Circuit-Interrupter (GFCI), press reset button, the system would be standby, the indicator light display green, make sure the GFCI is effective by pressing the test button before using the bathroom.

