

# DELUXE MASSAGE CHAIR

The Global Health-Care and Massage Expert



User's Manual

Thanks for you choose our Deluxe Massage Chair. Before operating the Massager, please read this User’s Manual thoroughly for the correct methods of usage, especially the notes on Safety.

This manual should be kept available for future reference after you have read it through.

Contents

Important Safety Instructions ..... 1-4

Names of Parts and Functions..... 5-7

Installation of Parts..... 8-12

Remote Controller Instruction..... 13-16

Massage Programs..... 17-26

Care and Storage.....27

Specifications.....27

Troubleshooting.....28



# Important Safety Instructions

## DANGER

- To reduce the risk of electric shock:
1. Always unplug this appliance from the Electrical Outlet immediately after using and before cleaning.

## WARNING

- To reduce the risk of burns, fire, electric shock, or injury to persons:
1. This appliance should never be left unattended when plugged in. Unplug from outlet when not in use, and before putting on or taking off parts.
  2. Close supervision is necessary when this appliance is used by, on, or near children, invalids, or disabled persons.
  3. Use this appliance only for its intended use as described in this manual. Do not use attachments not recommended by the manufacturer.
  4. Keep the cord away from heated surfaces.
  5. Never operate the appliance with the air openings blocked. Keep the air openings free of lint, hair, and the like.
  6. Never drop or insert any object into any opening.
  7. Do not use outdoors.
  8. Do not operate where aerosol (spray) products are being used or where oxygen is being administered.
  9. Connect this appliance to a properly grounded outlet only. See Grounding Instruction.
  - 10.If the supply cord is damaged, it must be replaced by a special cord or assembly available from the manufacture or its service agent.

## GROUNDING INSTRUCTIONS

This product must be grounded. If it should malfunction or breakdown, grounding provides a path of least resistance for electric current to reduce the risk of electric shock. This product is equipped with a cord having an equipment-grounding conductor and a grounding plug. The plug must be plugged into an appropriate outlet that is properly installed and grounded in accordance with all local codes and ordinances.

## DANGER

Improper connection of the equipment-grounding conductor can result in a risk of electric shock. Check with a qualified electrician or serviceman if you are in doubt as to whether the product is properly grounded. Do not modify the plug provided with the product if it will not fit the outlet, have a proper outlet installed by a qualified electrician.

This product has a grounding plug. Make sure that the product is connected to an outlet having the same configuration as the plug. No adapter should be used with this product.

PLEASE SAVE THESE SAFETY

# Important Safety Instructions

## 1. Usage Environment

- Do not use your Chair in an excessively humid or dusty environment, as it may cause electrical shock or machine trouble.
- Do not put your Chair in room temperature higher than 40°C.
- Do not expose your Chair to heaters, stoves or direct sunlight.
- Do place and use your Chair on a flat floor level.

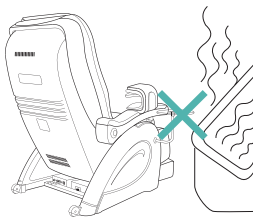



CAUTION

You should use the Chair in a cool room, do not increase the room temperature abruptly. It is recommended that you increase the temperature gradually to a normal Level. If you want to move the Chair that stored in a cold place to a warm place, it is advisable to use it one hour later. Machine trouble may be resulted when a cold machine is being used in a warm room suddenly.

## 2. Unsuitable Users

The following users must consult their doctor before use:



CAUTION

- Those who are under medical care or feel unwell.
- Those who are suffering from malignant tumours.
- Those who are suffering from severe heart diseases.
- Women who are pregnant or menstruating.
- Those who are under medical rest or rest cure ordered by doctors.
- Those with spinal disorders, bent or abnormal spinal conditions caused by past accident or illness.
- Those who have high fever.



## 3. Safety Precautions During Use

- To ensure safe and correct use of the Chair, do not operate the Chair without reading this operation manual carefully.
- Do not use the Chair with other therapeutic equipment or electric blanket, etc, as it may result in inefficacy or injury.
- Do not allow children or pets to play around the Chair, i.e. behind the Backrest, under the seat or Footrest of the Chair. It may result in injury during operation of the Chair.

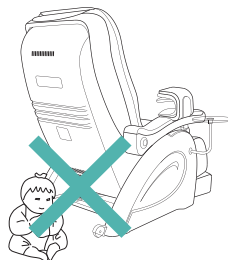

# Important Safety Instructions

- Do not rest or place heavy objects on the Armrests, Footrest or Backrest. It may result in machine trouble or injury to the user should these objects topple.
- Do not use the Chair when your body is wet.
- Do not operate the Chair with wet hands.
- Continuous long application of the massage at a position of your body may result in excessive stimulation and may be counter-effective.
- Do not insert your hand or foot along the paths of the Massage Nodes during the operation of the Chair, as it may cause injury to the user.



CAUTION

- Always sit in an upright position during the operation of the Chair.
- You may place a blanket or towel over the Backrest if you prefer a softer massage.
- Using the Massage Chair as a bed is not encouraged.
- Do not apply Massage Nodes directly on the head, joints of elbows and abdomen, etc.
- The recommended usage time is 15 minutes, however, you are encouraged not to use more than 5 minutes on the same spot.

## 4. When the Chair Should Not be Used

In the following events, please switch the power OFF immediately and disconnect the AC power cord from the Electrical Outlet.  
Contact our centre for servicing:

- If the Chair is spilt accidentally with water or not in operation, continuous to use under these conditions may result in electrical shock.
- If abnormal or severe pain is felt during massage, stop operation immediately and consult your doctor.
- If you find any malfunction or any other abnormal condition during operation.
- If there is a power failure, injury may be caused when power is back unexpectedly.
- If there is severe lightning.

**NOTE:** Lift the Backrest Pad regularly to check for tears in the upholstery of the Central Cloth

## 5. Assembly and Repair of the Chair



- Do not disassemble the back cover from the Chair, touching the inside mechanisms of the Chair may result in electrical shock.
- The Chair must only be serviced or repaired by our Service Centre, and user must not disassemble or repair the Chair oneself.

# Important Safety Instructions

## 6. Things to Note about Power Plug and Cord

- Check that the voltage corresponds with the specifications indicated for the Chair (only for alternative current).**
- Do not disconnect the AC Plug from the Electrical Outlet roughly.
  - Do not connect or disconnect the AC Plug from the Electrical Outlet with wet hands. It may result in electrical shock or machine troubles.
  - When disconnecting the AC Plug, pull it out by holding the plug and not by the cord.
  - Although the operation will be stopped automatically by the Auto-Timer function, do not fail to switch off the Main Switch after operation.
  - Do not place the AC cord under the Chair as it may damage the cord and result in fire or electrical shock.
  - Do not use the Chair if the power cord/pulg is damaged, use attachments that recommended by our company only .
  - Do not use the Chair if the Electrical Outlet is excessively loose.

## 7. Caution for the Remote Controller

- Do not sit, step or place heavy objects on the Remote Controller.
- Do not drop the Remote Controller.
- Do not exert excessive force on the Remote Controller.
- Do not operate the Remote Controller with wet hands.
- Do not operate the Remote Controller using sharp-edged or hard objects, this may result in damage.
- It is recommended to place it in the Remote Controller Support when not in use.

## 8. Caution for the Glass Tea Table

- The maximum load is 5kg.
- Do not place heavy objects on it, only small lightweight items such as books, keys and cell phone recommended.
- Do not let children hammer the Glass Tea Table by something hard.

# Names of Parts and Functions

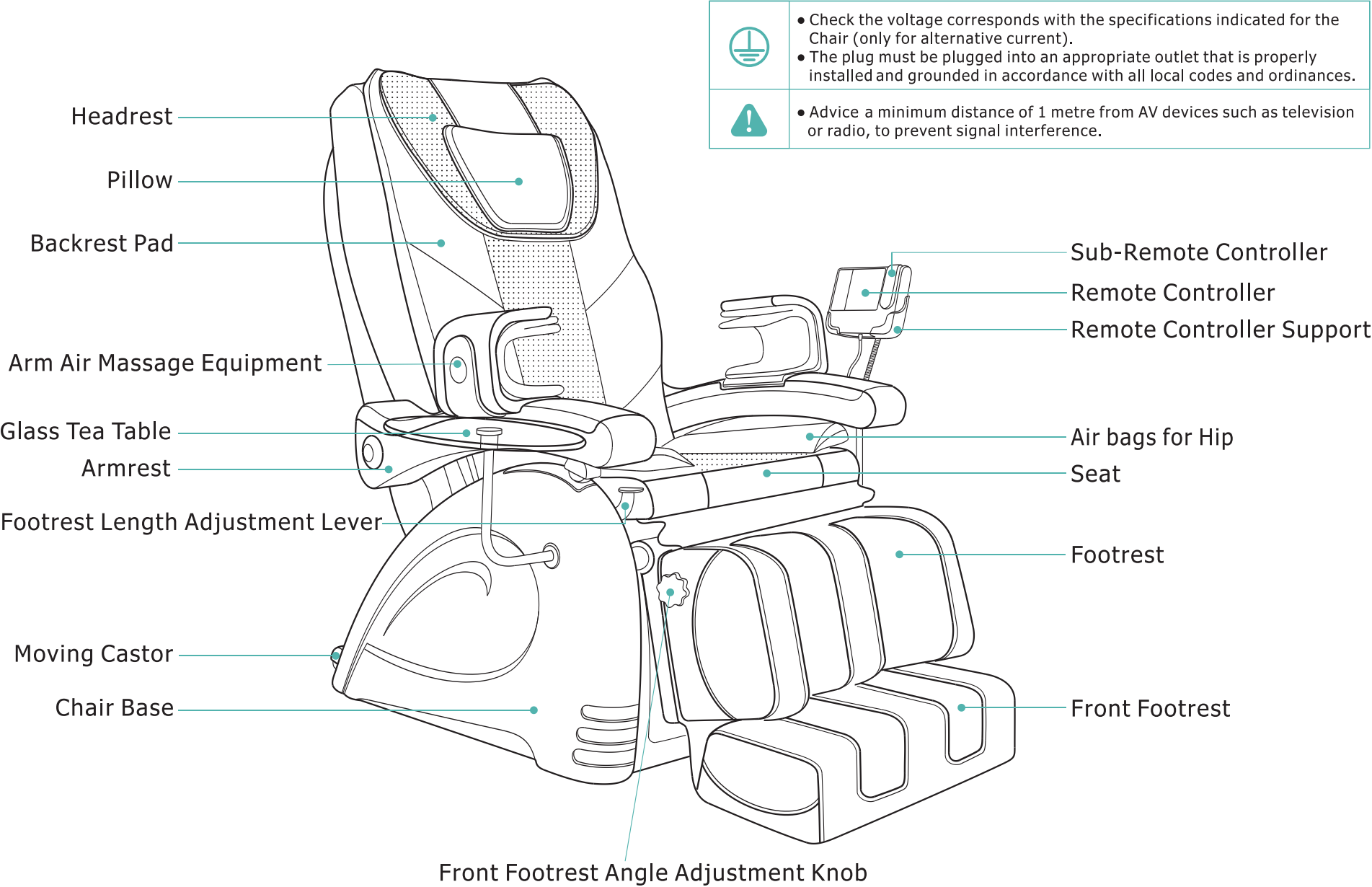

# Names of Parts and Functions

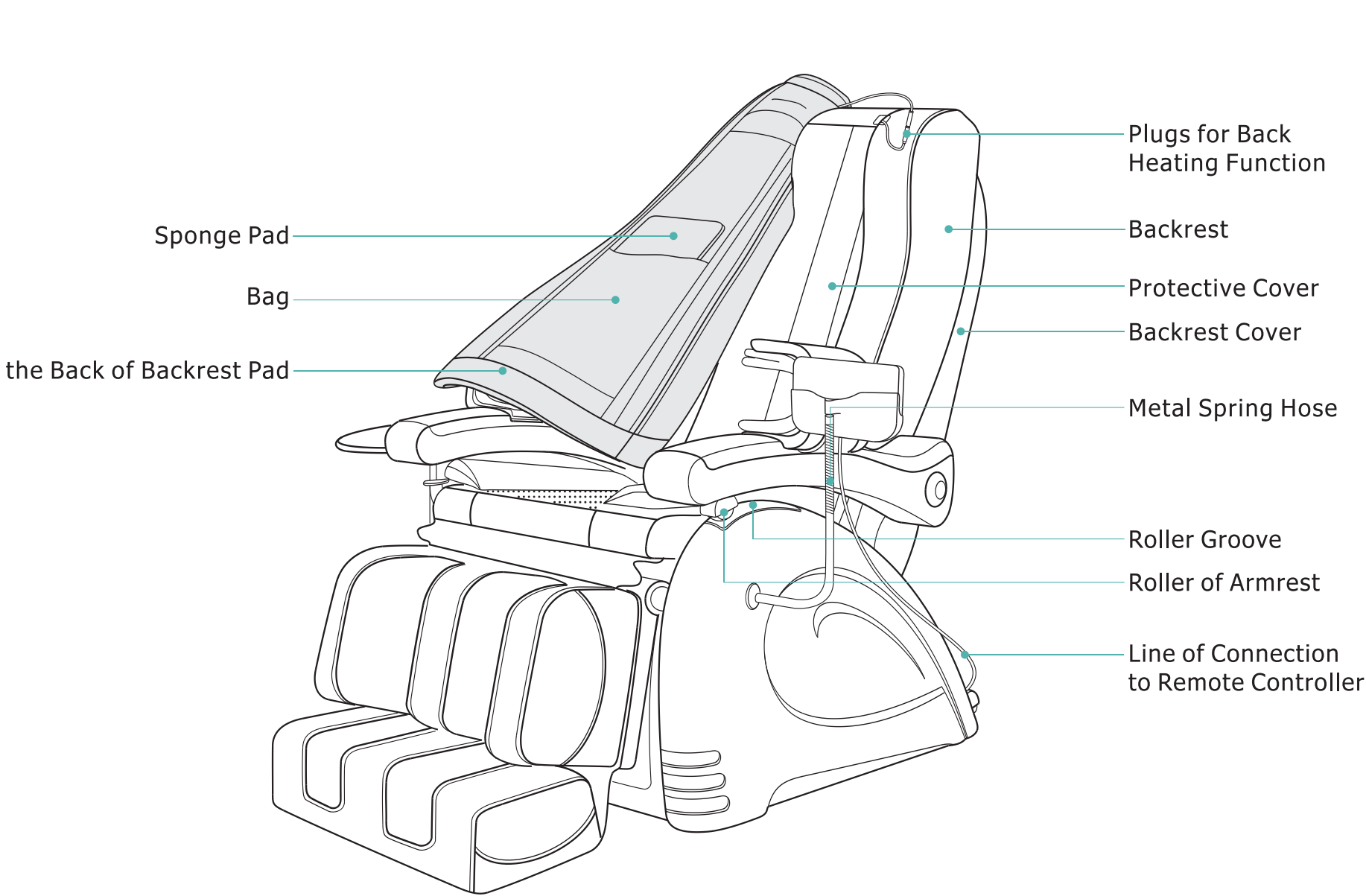



# Names of Parts and Functions

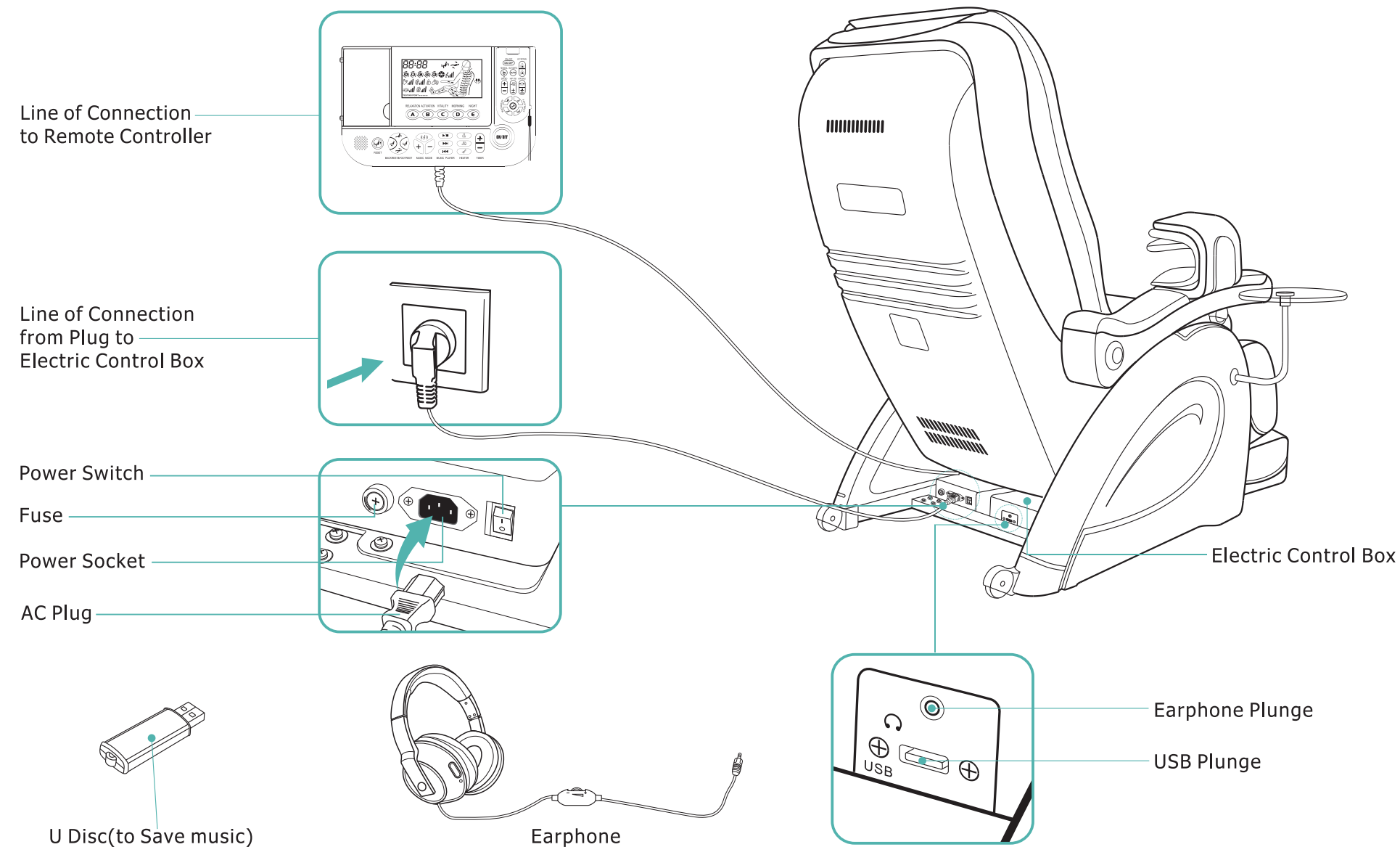

# Installation of Parts

## Arm Air Massage Equipment Installation

- 1.Insert the Air Tubes of Arm Air Massage Equipment into the hole of Armrest.
- 2.First,open the Upper Cover of Armrest and fix securely by 4 screws. Second, connect the air tubes by Y-shaped Air Tubes connector and fasten the Air Tubes by Nylon Cable Ties to avoid air leaking.
- 3.Close the Covers and fix securely by 3 screw.

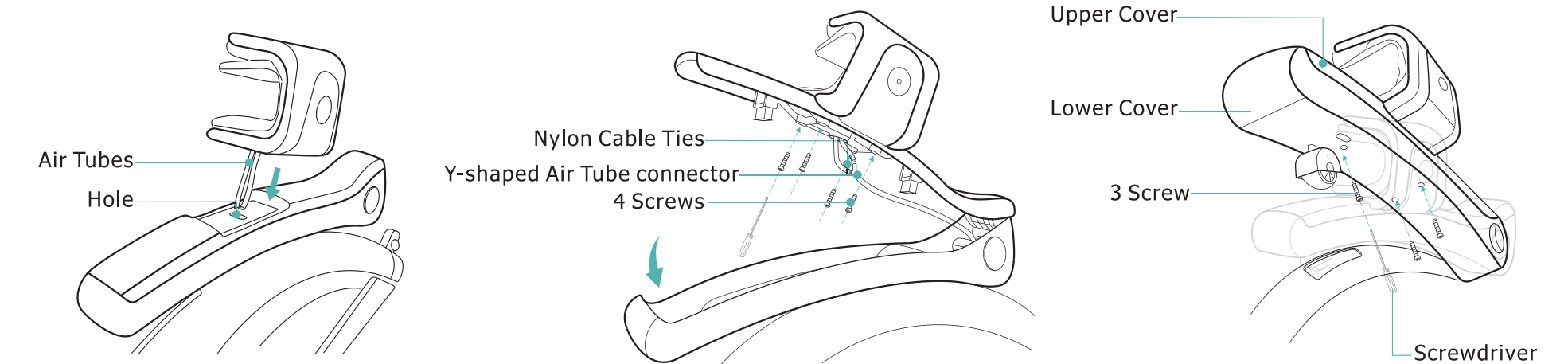

## Seat Cushion Installation

- 1.Insert the Air Tubes marked with the same color end to end(③-③, ④-④). To separate, pull them out only.
- 2.Connect the Data Cables with the same color end to end(①-①, ②-②).To separate, press the tail-end of the small hook down then pull the plug out.
- 3.The Seat Cushion is attached to the seat support with velcro tapes.

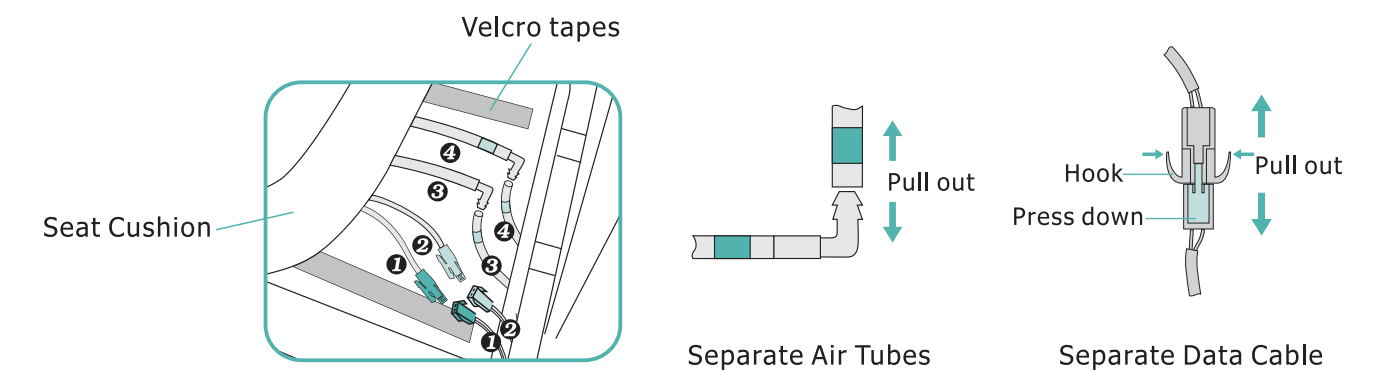

# Installation of Parts

## Expand/Folding the Chair

- To expand, please raise the Backrest to an upright position until a “click” sound is heard.
- To fold it for storage:
  1. Remove the Headrest, Pillow and Backrest Pad.
  2. Pull the Backrest Folding Lever up.
  3. Push the Backrest forward.



- Take care not to fold abruptly.
- Be careful not to get hand or fingers caught between the Armrest and Backrest.

1. Raise Backrest to an upright position.

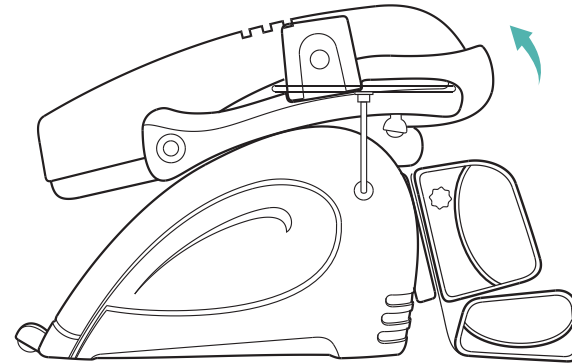

2. Pull the Backrest Folding Lever up to release it from lock position.

3. Push the Backrest forward to fold.

Backrest Folding Lever

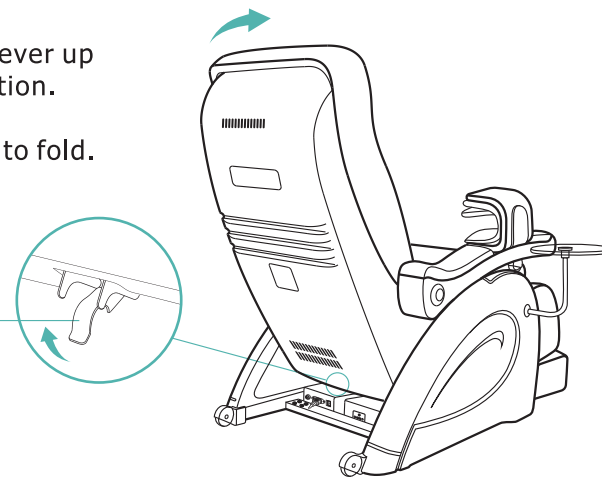

## Placing of the Chair

- Secure sufficient space around the Chair for reclining purpose.
- Make sure that there is an allowance of more than 45cm in the front of and 75cm behind the Chair.



CAUTION

- Put a carpet under the Chair to prevent scratching of the flooring.
- Make sure that there is no obstruction behind the Chair for a safe recline during operation.

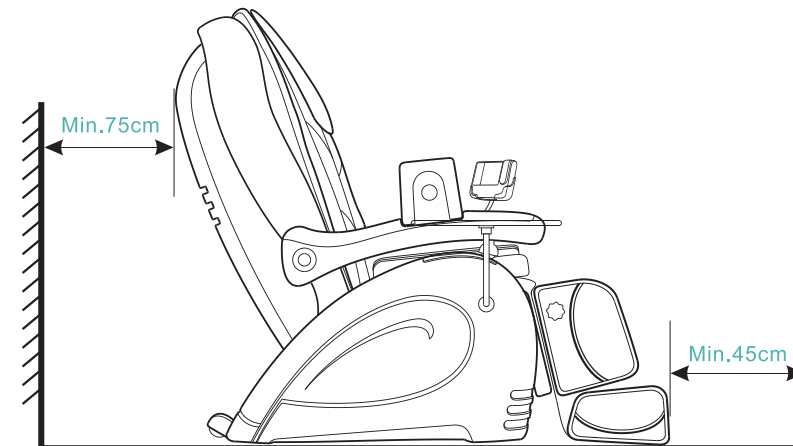

# Installation of Parts

## The Remote Controller Support Installation

- Install the Support Pole at the left side of Chair Base and fix securely by 3 screws then push the Cap2 onto the bottom of the support.
- Fix the Remote Controller Support to the Support Pole with Rubber Tube and tightened it by a screw then push the Cap1 onto the top of Remote Controller Support.
- Installation/Removal of Remote Controller: 1.Installation: insert it from the top. 2.Removal: hold the top and pull it upward.

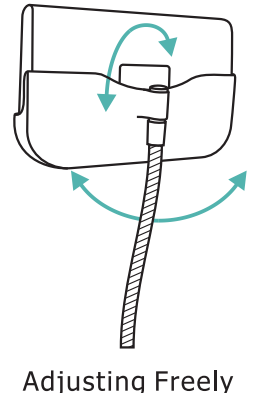
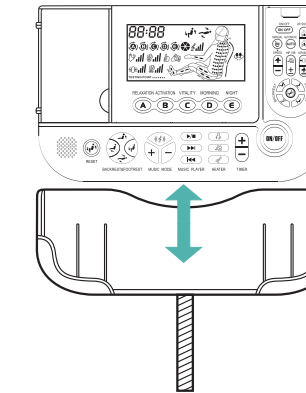
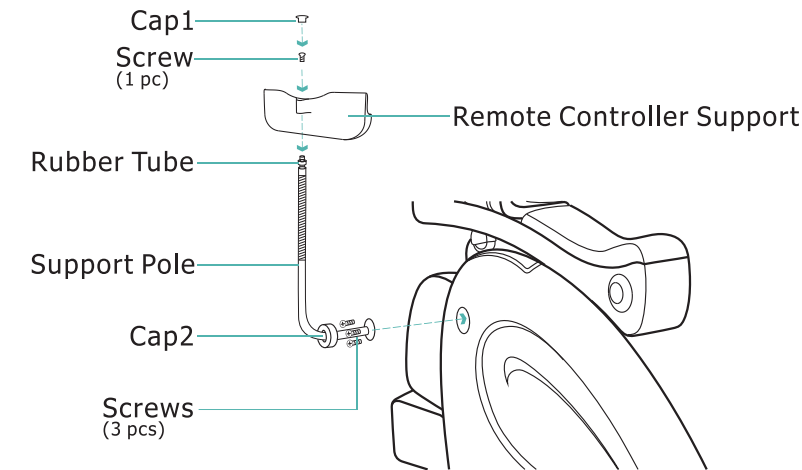

Adjusting Freely

## The Glass Tea Table Installation

1. Align the bottom of the Glass Tea Table Support to the hole in the right side of Chair Base and fix securely with 3 screws by Inner Hexagon Spanner. Push the cap onto the bottom of the support.

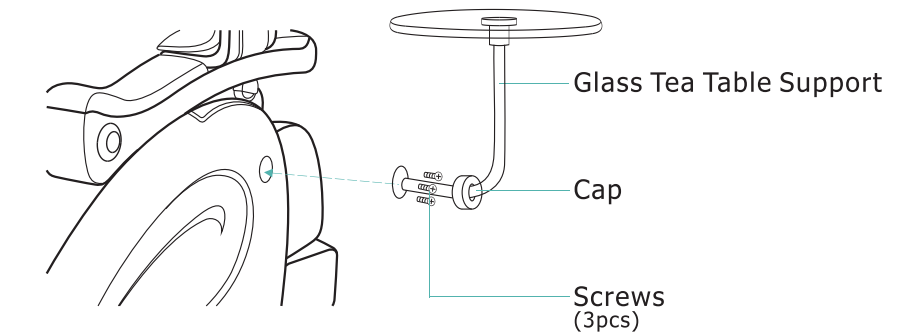

# Installation of Parts

## How to Place the Cell for Sub-Remote Controller

1. Push the front of the Cell Cap while simultaneously pull it out.
2. Insert a round 3V Cell into the Cell Bucket.
3. Close the Cell Cap and it will be ready to work.

⚠ Long time no use, please take the cell out.

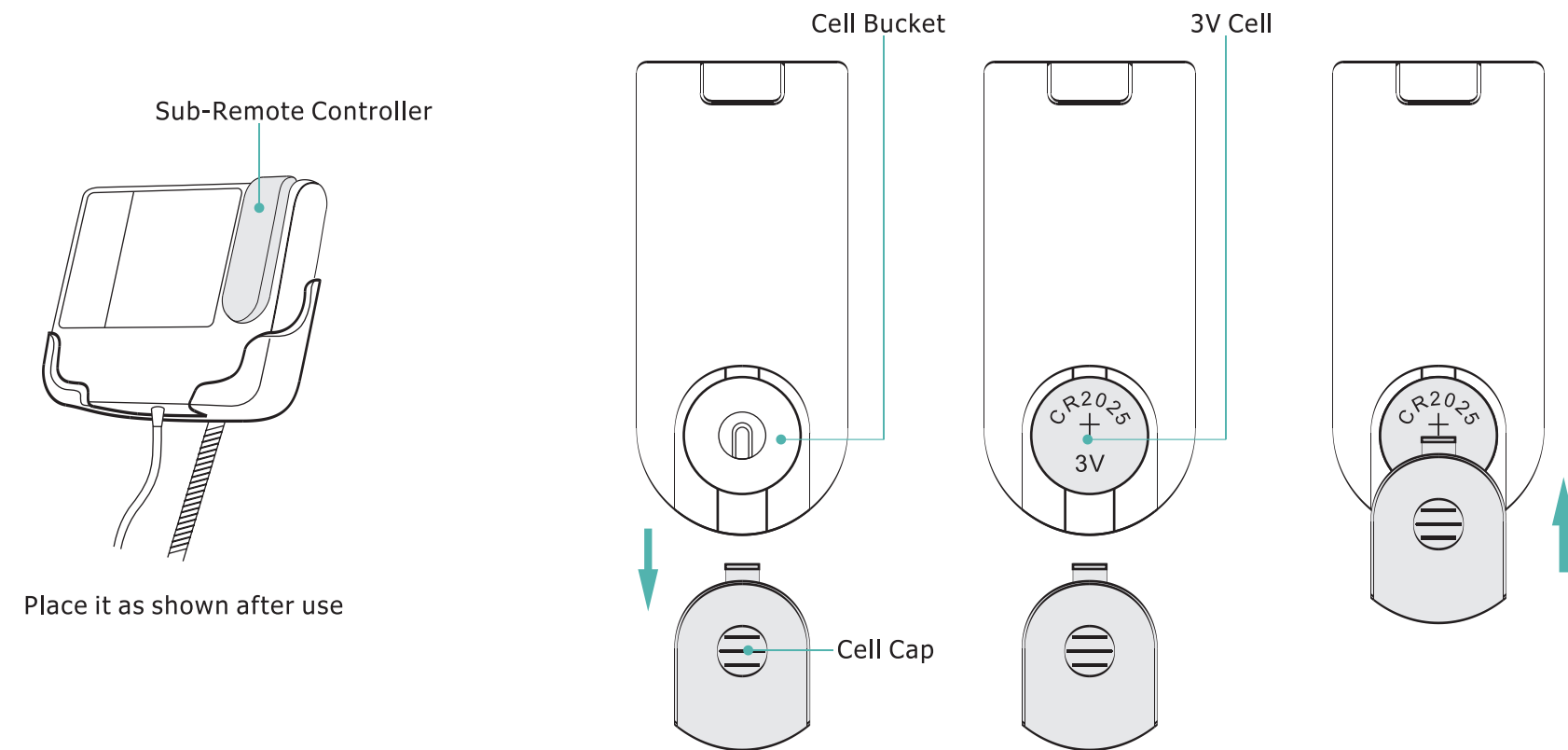

# Installation of Parts

## Backrest Pad Installation

- Backrest Pad is attached to the Backrest by zipper, to load or unload Backrest Pad, zip the zipper only. **(A)**
- Install Back Heating Function:
  - a. Insert plug ① with plug ② end to end only;
  - b. To separate, pull them out.
- Placing of the Sponge Pad: one Sponge Pad is provided for you to place it into the Backrest Pad to help absorb some of the roller stimulation. Remove the Sponge Pad if you prefer a more intense massage. **(B)**
- Turn the Backrest Pad to behind the back of the Chair if you prefer a more intense massage. **(C)**

⚠ CAUTION

- Do not use the Heating Function at the same spots for a long time.
- There is risk of the cryogenic burn.

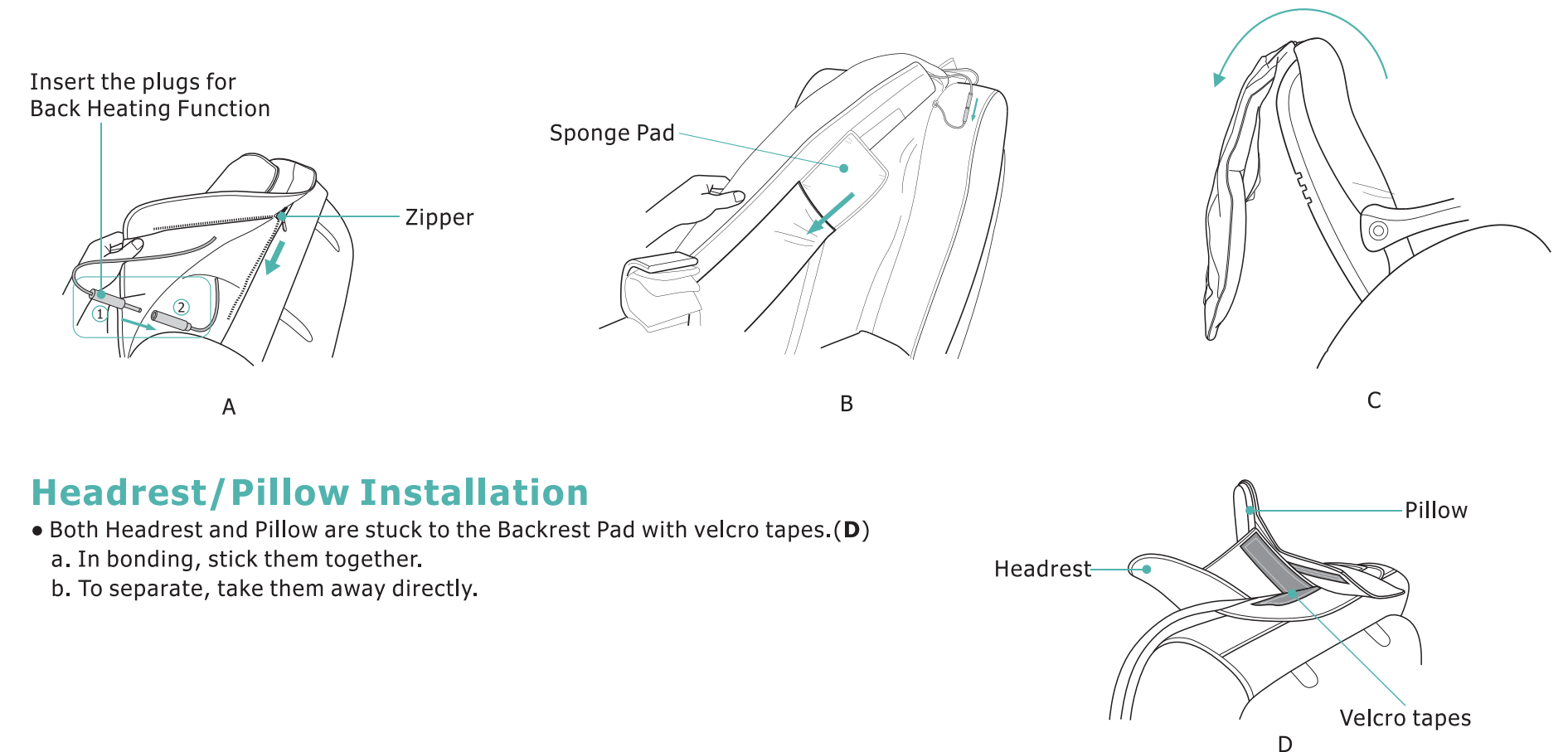

## Headrest/Pillow Installation

- Both Headrest and Pillow are stuck to the Backrest Pad with velcro tapes. **(D)**
  - a. In bonding, stick them together.
  - b. To separate, take them away directly.



# Remote Controller Instruction

## Remote Controller

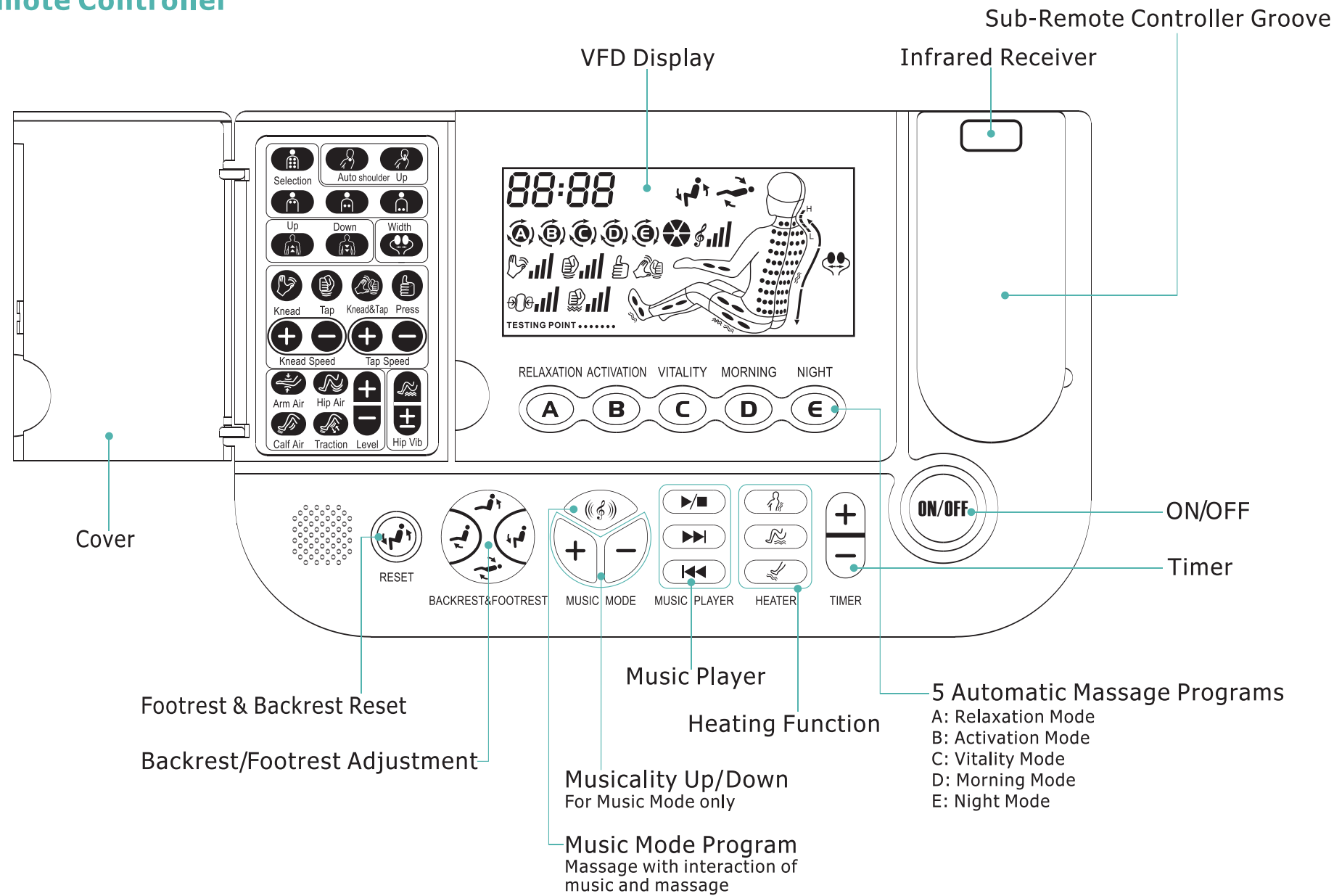

# Remote Controller Instruction

## Manual Remote Controller Panel

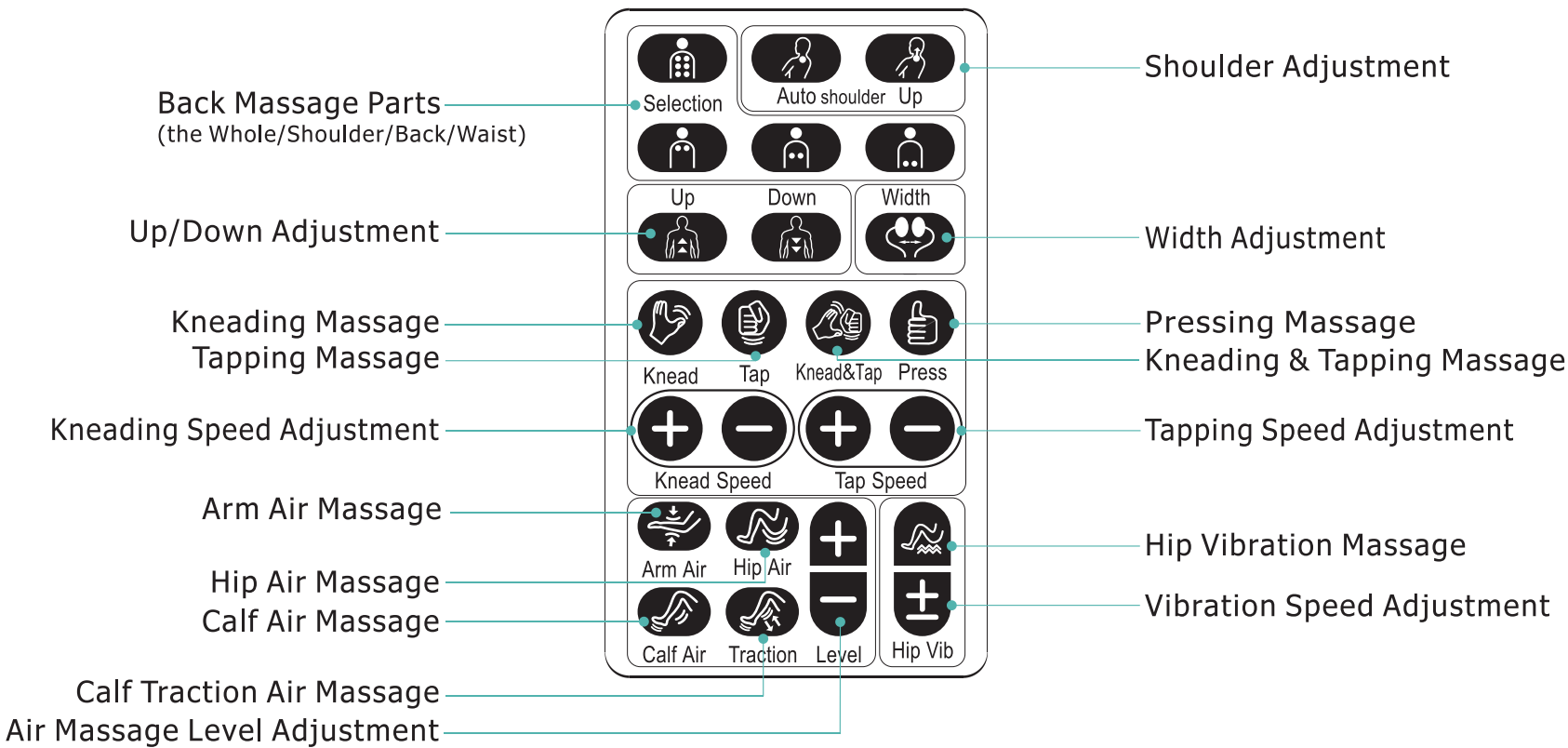

# Remote Controller Instruction

## VFD Display

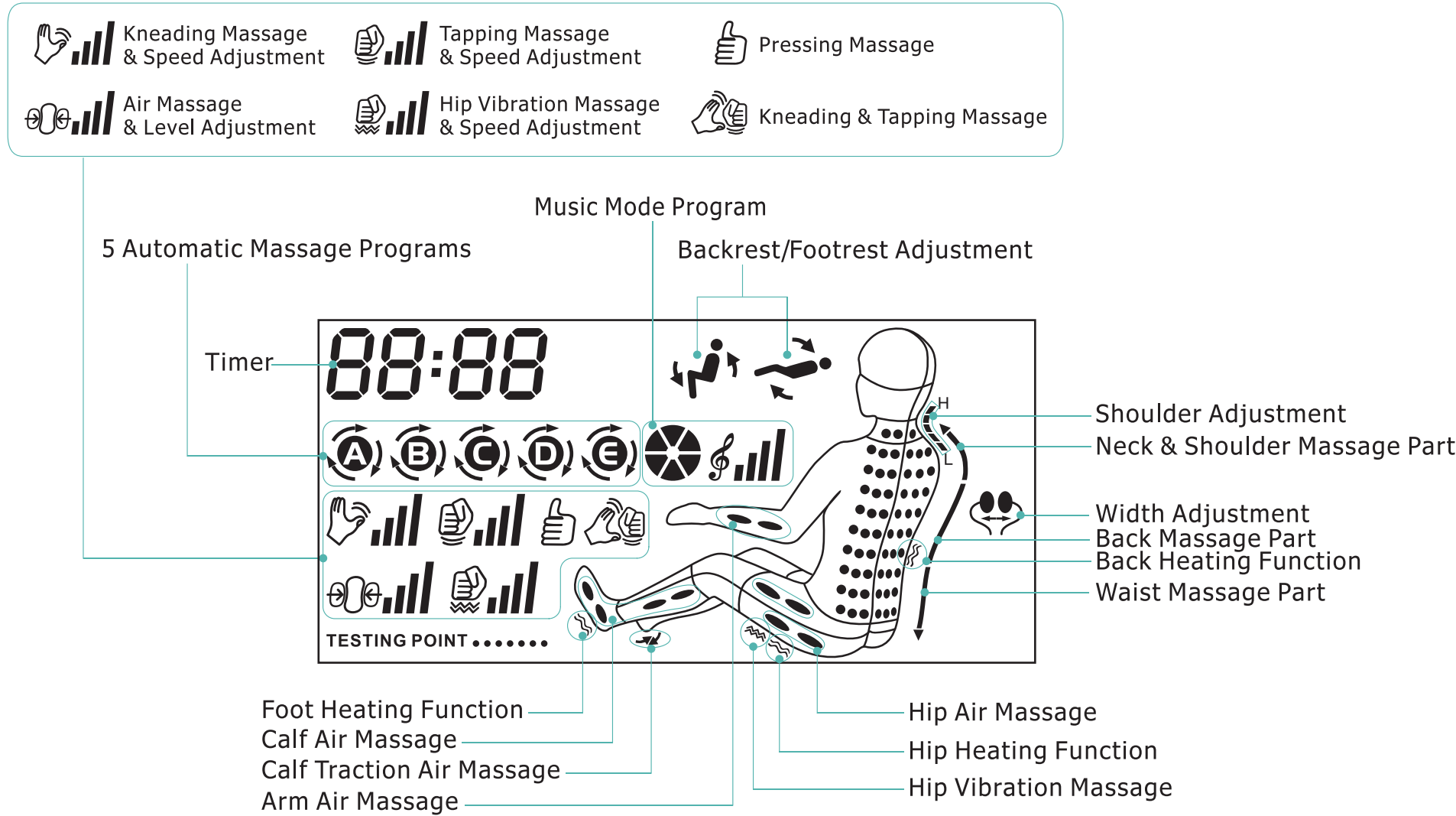

# Remote Controller Instruction

## Sub-Remote Controller with Infrared Ray

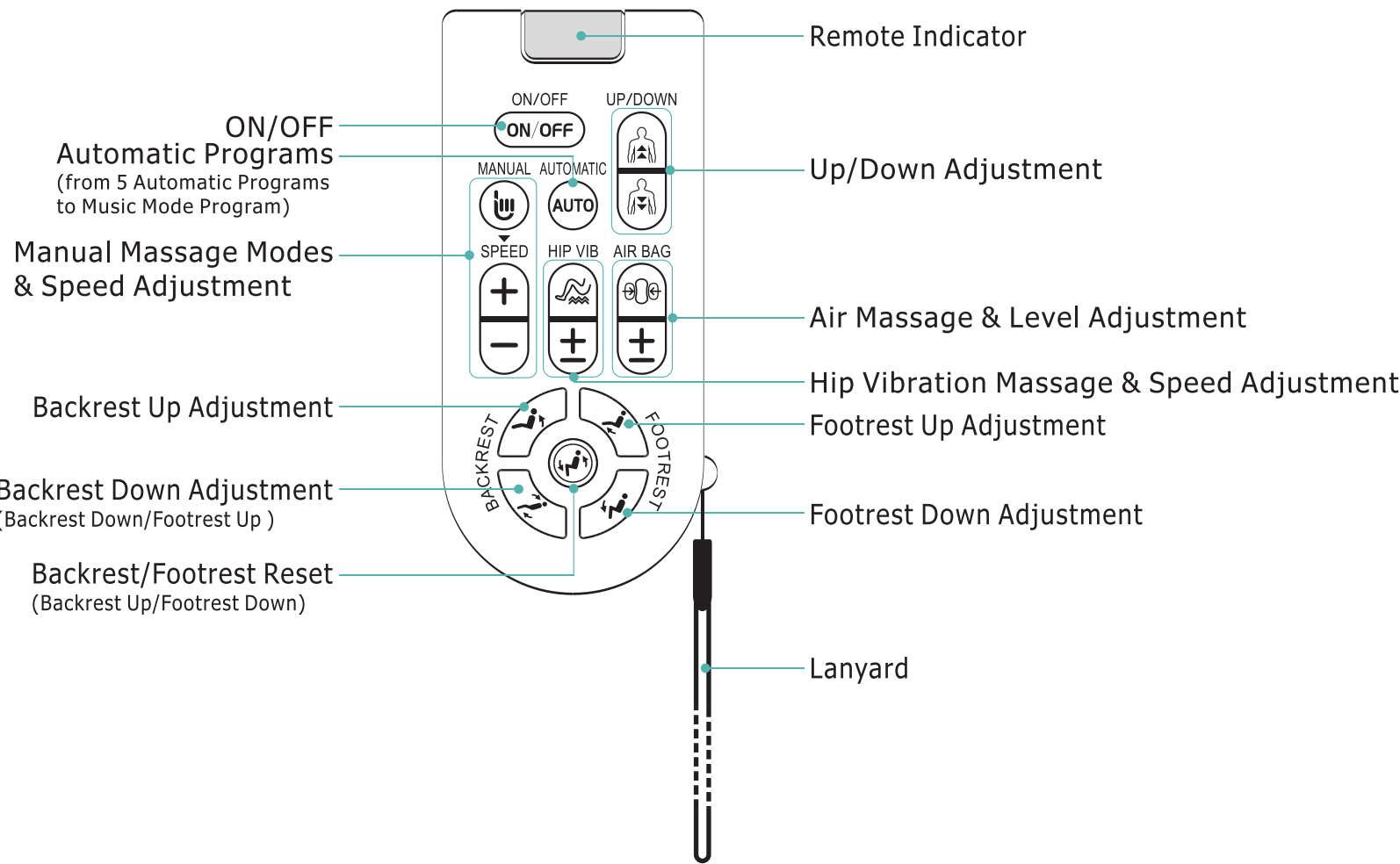

# Massage Programs

## Power On

- 1.Connect the AC Plug to the Electrical Outlet.
- 2.Turn on the Main Power Switch located on the Electric Control Box.
- 3.Press the “ON/OFF” button, it is ready to work after scanning the shoulder position.

**CAUTION**

- Make sure that the AC cord is not placed under the Chair Base.
- Make sure that all switches are at the OFF position (including the Main Power Switch) before the AC Plug is connected to an Electrical Outlet.

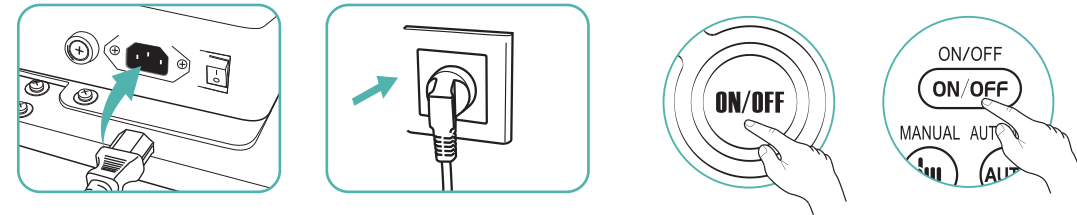

## How to Use the Reclining System

### Backrest

- To recline: Press the “Backrest Down” button until the Backrest is down and Footrest is up to your desired angle.
- To incline: Press the “Backrest Up” button until the Backrest is up to your desired angle.

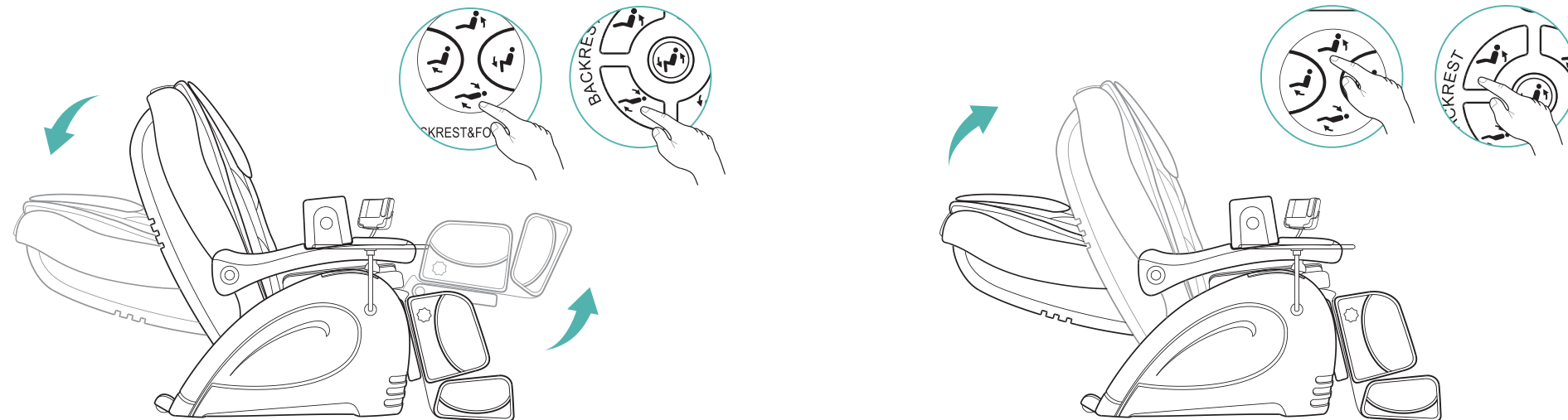

# Massage Programs

## Footrest

- 1.To lift: Press the “Footrest Up” button until the Footrest is upward to your desired height.
- 2.To lower: Press the “Footrest Down” button until the Footrest is downward to your desired height.

## Reset

- To reset: Press the “Reset” button, the Backrest and Footrest is to the initial position.

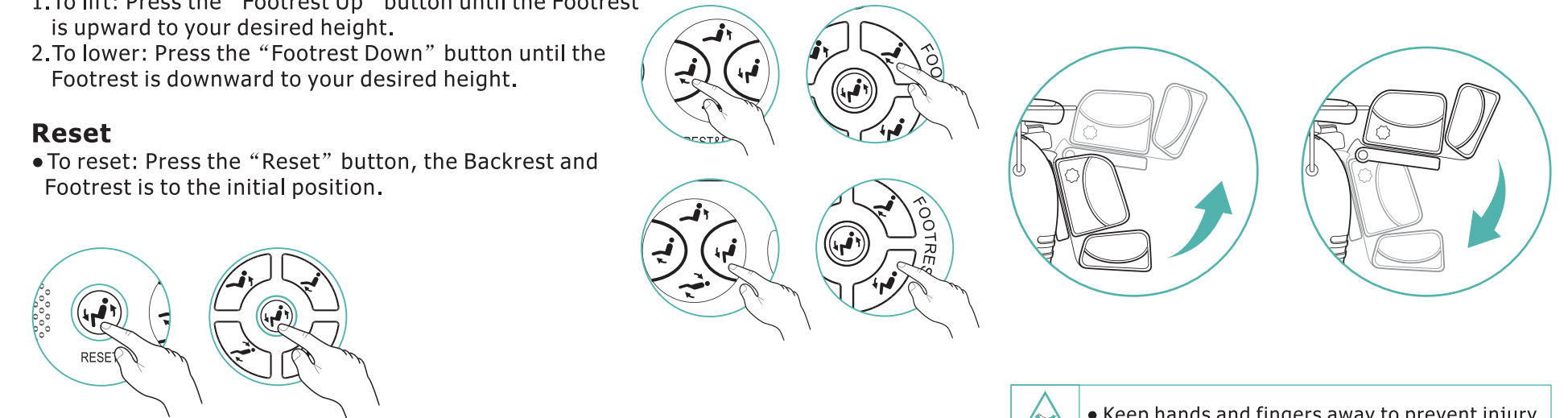

## How to Adjust the Front Footrest Angle

The angle of the front Footrest could be adjusted to suit for users by Front Footrest Angle Adjustment Knob as shown.

- 1.Rotate it counterclockwise slightly and adjust the angle freely with feet. Release it to be locked.
- 2.Reset: Just rotate it counterclockwise slightly again.

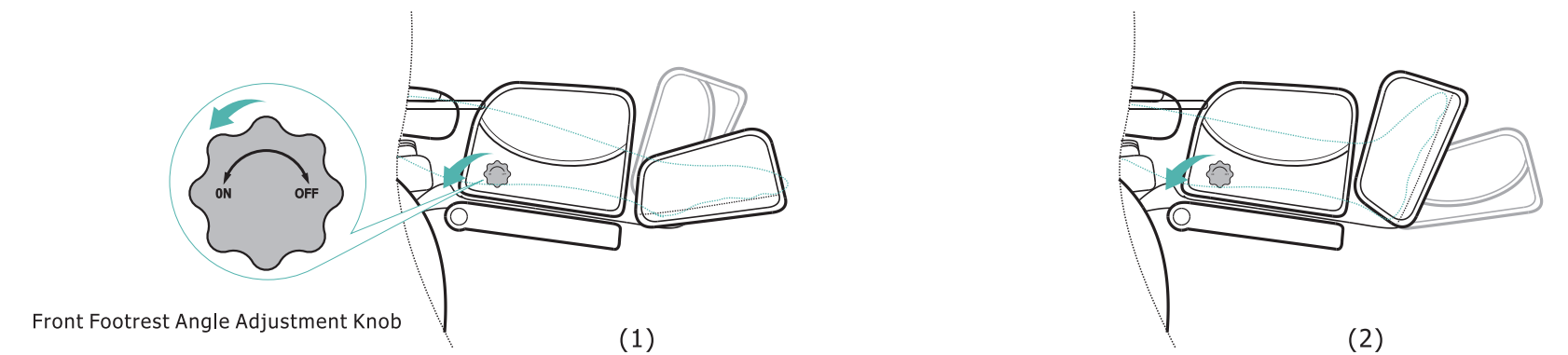



# Massage Programs

## How to Adjust the Length of the Footrest

The length of the Footrest can be adjusted to the comfort of the user by lifting the Footrest Length Adjustment Lever.

- 1.To lengthen: Lift the lever and push out the Footrest with your feet to get the proper position and loosen the lever to lock the position.
- 2.To shorten: Just lift the lever and the Footrest is to the initial position automatically.



- Do not exert excessive force on the Footrest Length Adjustment Lever.

Footrest Length Adjustment Lever

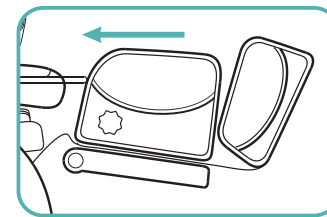
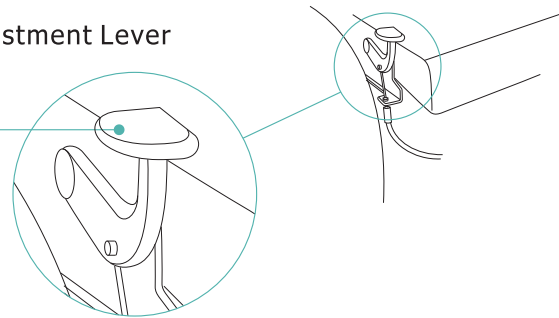

Shorten

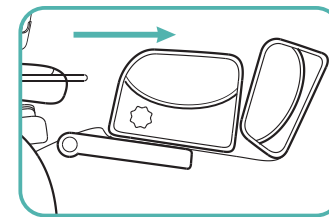

Lengthen

## Moving the Massage Chair

- Move: There should be two more person, one hold the Footrest upward and the other turn the Backrest backward, causes the moving castors to be well-grounded then push it to move.



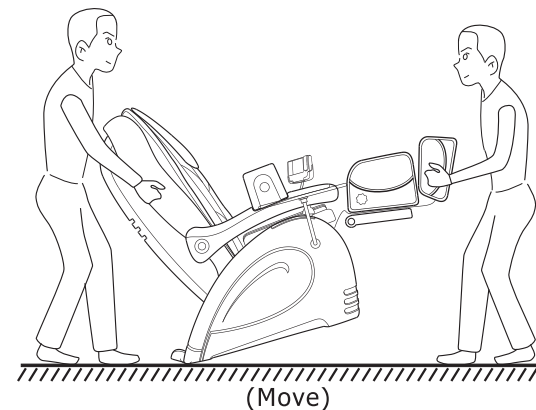

CAUTION

- Please pull out AC Plug from Electric Outlet before moving Chair.
- Do not move the Chair when someone is sitting on it.
- The Chair is rather heavy. Take sufficient care when lifting it.



# Massage Programs

## Timer

- 1.The default massage time is 30 minutes and the massage procedure will be closed automatically after 30 minutes.
- 2.How to set the time: a. Press button  to be increased by 5 minutes  
b. Press button  to be decreased by 5 minutes



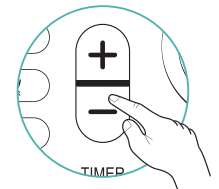

After setting of the time, the machine will begin to count down till the remaining time is zero and then the procedure will be closed automatically.

- 3.In changing of Automatic Massage Programs and individual procedure, the remaining time won't be changed.



## Choosing Back Massage Parts

- Press “selection” button, you can choose one of 4 massage parts. When it is chosen, the correspond icon is lighting on the VFD.

-  The Whole course: It will give massage up and down from neck to waist.
-  Shoulder Part: It will give massage up and down from neck part to the upper back.
-  Back Part: It will give massage up and down from upper back to lower back.
-  Waist Part: It will give massage up and down from lower back to waist part.

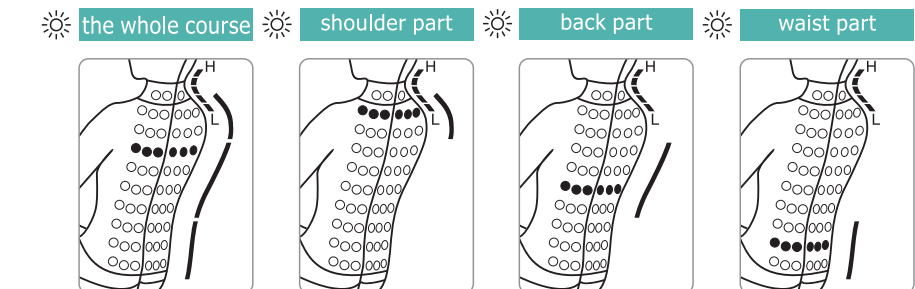
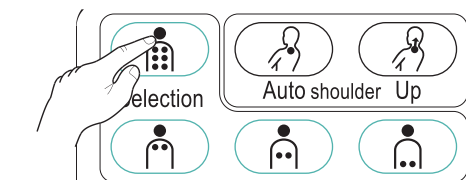

## Up/Down Massage

- This function is for Kneading Massage, Tapping Massage and Kneading & Tapping Massage only.
- It is 2 method to use this function During Back Massage:
  - 1.Press “Up” or “Down” button continuously, the Massage Nods will move up or down. Release it, the nods will stop on your desired part.
  - 2.While the nods are massaging on you desired part, just press “Up” or “Down” button once and the nods will stop there for a spot massage.

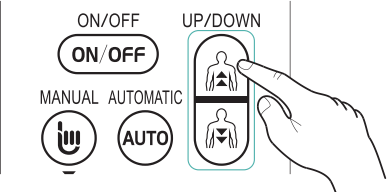
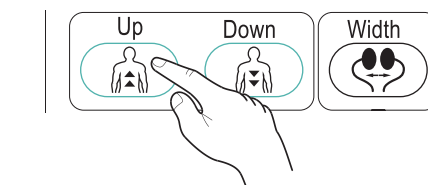

# Massage Programs

## Width Adjustment

- 1.It is suitable for Tapping Massage and Pressing Massage only.
- 2.Press “Width” button to adjust the massage width according to your desire.

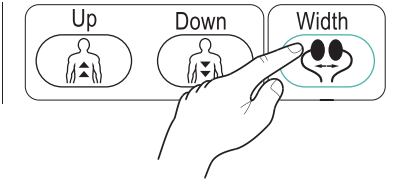

## After Use

- Press the “ON/OFF” button to stop massage.
- To avoid malfunction and accidents with children, do remember to switch off the Main Power Switch and disconnect the AC Plug from the Electrical Outlet after use.

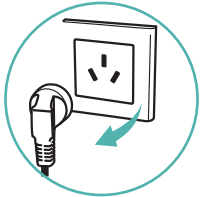

There are 3 series of massage: 1.Automatic Massage Programs 2.Massage along with Music Rhythm 3.Manual Massage Programs

## 1.How to Use the Automatic Massage Programs

This menu of 5 special massage programs which is designed to meet specific well goals with a simple touch of the Remote Controller. Choose from a range of 5 different kinds of pre-programed massages.

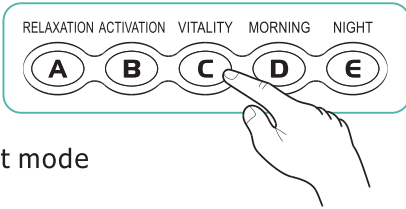

**A**-- Relaxation mode    **B**-- Activation mode    **C**-- Vitality mode    **D**-- Morning mode    **E**-- Night mode

The Automatic Massage Programs buttons **A** **B** **C** **D** **E**    The correspond icons **(A)** **(B)** **(C)** **(D)** **(E)** on the VFD

- To start massage, press any one of the 5 buttons, you can enjoy a continuous massage on the whole body. Press the buttons again to stop massage.

# Massage Programs

## 2.Massage along with Music Rhythm (Massage procedures with interaction of music and massage)

- 1.Download your favorite songs in Mp3 type into the U disc and insert it into the USB Plunge (on the Electric Control Box).
- 2.Connecting the Earphone to the Earphone Plunge and put on your head, press the “Music Mode” button for massage with music rhythm and adjust musicality intensity(4 grades).
- 3.Press “Music Player” button to select music and adjust the volume by the Volume Control of the Earphone.

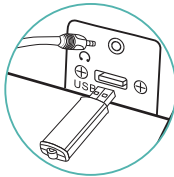

Earphone/U Disc

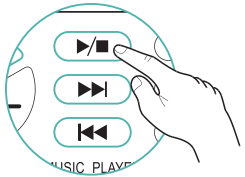

Music Player

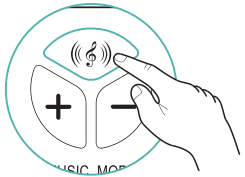

Music Mode Massage

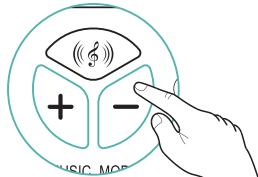

Music Intensity

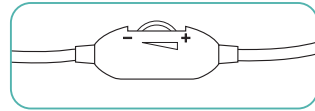

Volume Control

## 3.Manual Massage Programs

It allows you to mix and match from a choice of massage actions, you can adjust massage action’s speed, level or position to suit yourself.

### • A.4 Back Massage Programs:

- Kneading Massage
- Tapping Massage
- Kneading & Tapping Massage
- Pressing Massage

### • B.4 Air Massage Programs:

- Air Air Massage
- Hip Air Massage
- Calf Air Massage
- Calf Traction Air Massage

### • C.1 Vibration Massage Program:

- Hip Vibration Massage

### • D.3 Heating Function:

- Back Heating Function
- Hip Heating Function
- Foot Heating Function







Choosing of Manual Programs, please see the following form for detail.

Massage Programs	LCD	Speed Adjustment	Level	Width	Parts	Up/down
Kneading		<input checked="" type="checkbox"/>			<input checked="" type="checkbox"/>	<input checked="" type="checkbox"/>
Tapping		<input checked="" type="checkbox"/>		<input checked="" type="checkbox"/>	<input checked="" type="checkbox"/>	<input checked="" type="checkbox"/>
Kneading & Tapping		<input checked="" type="checkbox"/>			<input checked="" type="checkbox"/>	<input checked="" type="checkbox"/>
Pressing				<input checked="" type="checkbox"/>	<input checked="" type="checkbox"/>	
Hip Vibration Massage			<input checked="" type="checkbox"/>			
Arm Air Massage			<input checked="" type="checkbox"/>			
Hip Air Massage			<input checked="" type="checkbox"/>			
Calf Air Massage			<input checked="" type="checkbox"/>			
Calf Traction Air Massage			<input checked="" type="checkbox"/>			
Back Heating Function						
Hip Heating Function						
Foot Heating Function						









# Massage Programs

## A. Back Massage Programs





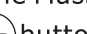



### 1.kneading Massage

- Press the “knead” button, it begins to Kneading Massage and the correspond icon is  lighting on the VFD.
- Press  button to select one of 4 massage parts.
- Press  or  button to adjust the Massage Nods position up or down for a spot massage.
- To adjust the speed, press the   button and the correspond icon will show on VFD Screen: .
- Press the “knead” button again to stop.



### 2.Tapping Massage

- Press the “Tap” button, it begins to Tapping Massage and the correspond icon is  lighting on the VFD.
- Press  button to select one of 4 massage parts and adjust the tapping massage width by press  button according to your desire.
- Press  or  button to adjust the Massage Nods position up or down for a spot massage.
- To adjust the speed, press the   button and the correspond icon will show on VFD Screen: .
- Press the “Tap” button again to stop.

### 3.Kneading & Tapping Massage





- Press the “Knead & Tap” button, it begins to Kneading & Tapping Massage and the correspond icon is  lighting on the VFD.
- Press  button to select one of 4 massage parts.
- Press  or  button to adjust the Massage Nods position up or down for a spot massage.
- Press the kneading Speed   button or Tapping Speed   button to adjust the speed and the correspond icon will show on VFD Screen: .
- Press the “Knead & Tap” button again to stop.

### 4.Pressing Massage

- Press the “Press” button, it begins to Pressing Massage and the correspond icon is  lighting on the VFD.
- Press  button to select one of 4 massage parts and adjust the pressing massage width by press  button according to your desire.
- Press the “Press” button again to stop.





# Massage Programs

## B. Hip Vibration Massage





- Press the “Hip Vib” button, it begins to Vibration Massage on Hip and the correspond icon  is lighting on the VFD.
- To adjust the speed, press the   buttons and the corresponding icon  is lighting on the VFD. There are 4 levels can be selected.
- Press the “Hip Vib” button again to stop.

## C. Air Massage Programs





### 1.Arm Air Massage

- Press the “Arm Air” button, it begins to Air Massage on Arm and the corresponding icon  with the icon of Arm part is lighting on the VFD.
- Press the   button to adjust the level and the corresponding icon  is lighting on the VFD. There are 4 levels can be selected.
- Press the “Arm Air” button again to stop.

### 2.Hip Air Massage

- Press the “Hip Air” button, it begins to Air Massage on Hip and the corresponding icon  with the icon of Hip part is lighting on the VFD.
- Press the   button to adjust the level and the corresponding icon  is lighting on the VFD. There are 4 levels can be selected.
- Press the “Hip Air” button again to stop.

### 3.Calf Air Massage



- Press the “Calf Air” button, it begins to Air Massage on Calf and the corresponding icon  with the icon of Calf part is lighting on the VFD.
- Press the   button to adjust the level and the corresponding icon  is lighting on the VFD. There are 4 levels can be selected.
- Press the “Calf Air” button again to stop.

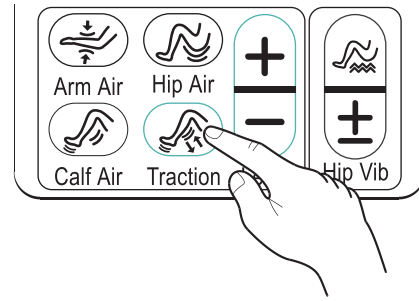

# Massage Programs



## 4.Calf Traction Air Massage

- Press the “Traction” button, it begins to Traction Air Massage on Calf and the correspond icon  with the icon of Calf is lighting on theVFD.
- Press the  button to adjust the level and the corresponding icon  is lighting on the VFD. There are 4 levels can be selected.
- Press the “Traction” button again to stop.

## D. Heating Function

### 1.Back Heating Function

- Press the “Back Heating” button, it begins to Back Heating Function and the correspond icon  of the back part is lighting on theVFD.
- Press the button again to stop.

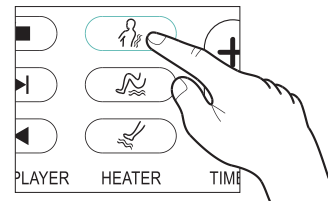

### 2.Hip Heating Massage

- Press the “Hip Heating” button, it begins to Hip Heating Function and the correspond icon  of hip part is lighting on theVFD.
- Press the button again to stop.

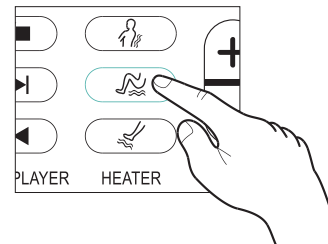

### 3.Foot Heating Massage

- Press the “Foot Heating” button, it begins to Foot Heating Function and the correspond icon  of feet part is lighting on theVFD.
- Press the button again to stop.

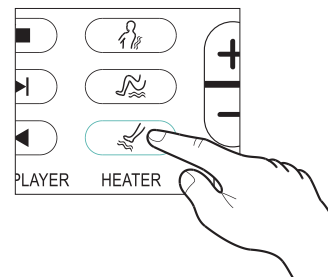

# Massage Programs



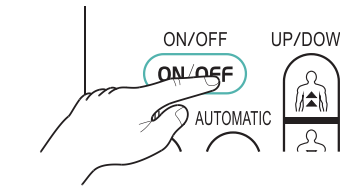

## How to Operate Sub-Remote Controller



### Power On





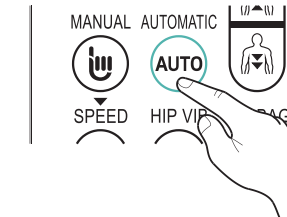

- Press “ON/OFF” button, the Massage Chair is ready to work.
- Press the button again to stop all massage programs.

### Automatic Massage Programs

- Press “AUTOMATIC” button, the Massage Chair begins to massage. There are 5 Automatic Programs      and Music Mode Program available. They can be chosen one by one by pressing the button and the correspond icons are lighting on the VFD. Under this condition, you can enjoy a continuous massage on the whole course of back and adjust the levels of Air Massage or Vibration Massage to suit individual needs.
- Press “AUTOMATIC” button for the 7th time to stop massage.



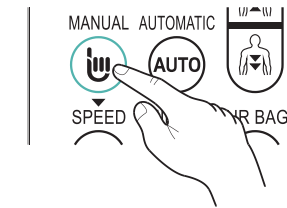

### Manual Massage Programs

- Press “MANUAL” button, the Massage Chair begins to massage. There are 4 Manual Massage Programs available that is Kneading Massage, Tapping Massage, Kneading & Tapping Massage and Pressing Massage. They can be chosen one by one by pressing the button and the correspond icons , , ,  are lighting on the VFD. Meanwhile press  or  button to adjust the level and 4 levels are available.
- Press “MANUAL” button for the 5th time to stop massage.



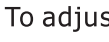

### Hip Vibration Massage

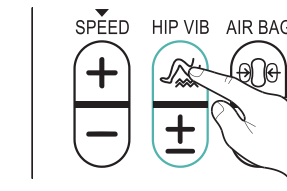
- Press the “HIP VIB” button, it begins to Vibration Massage on Hip and the correspond icon is  lighting on the VFD.
- To adjust the speed, press the  button and the corresponding icon  is lighting on the VFD. There are 4 levels are available.
- Press the “HIP VIB” button again to stop massage.



### Air Massage

- Press the “AIR BAG” button, it begins to Air Massage on Hip, Calf and Arm. Meanwhile the corresponding icons  with the icons of choosing parts are lighting on the VFD.
- Press the  button to adjust the levels and the corresponding icons  are lighting on the VFD. There are 4 levels are available.
- Press the “AIR BAG” button again to stop massage.

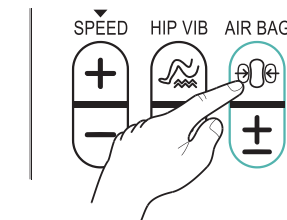

# Care and Storing

## 1.Storing the Chair

- Make sure the power is turned off and pull out the plug from the outlet when it is kept.
- Wipe off dust and dirt from the Chair. Keep the Chair clean and away from places of high humidity. Damp and dust will shorten the machine's life and may become the causes of mouldy or dirty marks.
- If the Chair is not in use for a long period of time, cover the Chair with a dustproof cover to protect it from dust.



- Please keep away from direct sunlight or heating appliances like heat stove. It could cause discolouration or deterioration.

## 2.Cleaning of Remote Controller

- Remove fouling on the Remote Controller with a piece of dry cloth. As a wet cloth may cause damage.

## 3.Cleaning of Leather

- To clean the leather sections, wipe with a piece of cloth impregnated with neutral detergent at first. Then remove the detergent with a soft cloth wetted with water and air dry.
- Use a piece of dry cloth to wipe over the painted areas.



- Don't use diluents, volatile oil or bleaching powder will cause discolouration or cracks.
- Do not use the iron.

## Specifications

Name: Deluxe Massage Chair

Rated Voltage: AC100-120V ☐ AC220-240V ☐

Rated Frequency: 50/60Hz

Power Consumption: 260W

Working Time: 30minutes

Net Weight: 85kgs

※ **Note:** Specifications are subject to change without notice.

# Troubleshooting

If you encounter problems with the operation of the Chair, Please check the following points to see if they can be rectified. If the Chair still does not work or malfunctions, please switch off the Chair and remove the AC Plug from the Electrical Outlet. Contact our Service Center for servicing.

**Do not** disassemble or attempt to repair the Chair by yourself.

Conditions	Possible Cause or Action
Loud sound during Kneading, Tapping	These sounds are results of mechanical structure and are not indicators of machine trouble.
Knocking sound at the change of massage function	
Sound of the air pump	
The Chair does not operate by using the Remote Controller	Check the AC plug is firmly connected to the Electrical Outlet.
	Confirm that the main power is switched on.
Massage Nods stop moving	Do not lean too hard against the Backrest.
Stop working during the massage	Working too long, stop working for a moment.
	Overheat protection start, stop working for a moment.
	Time out (Timer) or power out.
	Fuse burned, please change it.
	The chair maybe is interfered by unsteady voltage, power it off and restart after a moment.
No hearing the mp3 music sound	Turn the volume control of earphone.
	Check the earphone connection, maybe is loose.
	Check the U disc, maybe is bad.
	Check the U disc, maybe is no mp3 music inside.
The Hip Air Massage do not work correctly	Please adjust the music intensity to highest level.
	Check the air tubes of the Seat Cushion that is fully connected and make sure the air tubes is unfold.
The Sub-Remote Controller is disable	Ensure the signal is fully accepted by the Remote Receiver.
	Replace the Cell.
Remote Controller emit fitful sound	One button is locked, please check and reset it.